

Manning Road
 St. Gregory's to Sylvestre Drive
 Town of Tecumseh
 August 12th, 2003



Town of Tecumseh

Property Ownership on Tecumseh Road
Between Bedell and Manning Rd

ROLLNO	NAME1	NAME2	ADDR1	ADDR2	CITY	PROVINCE	POSTCODE
150-04500	TECUMSEH TOWN		917 LESPERANCE		TECUMSEH	ON	N8N 1W9
170-00100	FTF INC		1192 LACASSE BLVD	1189	WINDSOR	ON	N8N 2C5
240-01600	SUNOCO INC		36 YORK MILLS ROAD		NORTH YORK	ON	M2P 2E9
170-00101	TECUMSEH PUBLIC UTILITIES		1189 LACASSE BLVD		WINDSOR	ON	N8N 2C7
230-23900	RINDLISBACHER, THOMAS JOSEPH	RINDLISBACHER, LISA MARIE	13219 HARVEST LANE		WINDSOR	ON	N8N 4N7
230-24000	RAYMOND CLAUDE AURELIEN	RAYMOND CAROLE MARY	13215 HARVEST LANE		WINDSOR	ON	N8N 4N7
230-22850	1100946 ONTARIO INC		13385 DESRO DR	RR 1	WINDSOR	ON	N8N 2L9
240-00850	GEORGE L DILLON CONSTRUCTION	COMPANY LIMITED	12630 RIVERSIDE DR E		WINDSOR	ON	N8N 1A3
240-00800	GEORGE L DILLON	CONSTRUCTION CO LTD	12630 RIVERSIDE DR E		WINDSOR	ON	N8N 1A3
240-00900	GEORGE L DILLON	CONSTRUCTION CO LTD	12630 RIVERSIDE DR E		WINDSOR	ON	N8N 1A3
240-01000	TOWN OF TECUMSEH		917 LESPERANCE ROAD		TECUMSEH	ON	N8N 1W9
240-01100	1109103 ONTARIO LTD		673 ERIE ST E		WINDSOR	ON	N9A 3Y1
240-01150	1109103 ONTARIO LTD		671 ERIE ST E		WINDSOR	ON	N9A 3Y1
240-01200	1128619 ONTARIO LIMITED		871 MICHAEL DR		WINDSOR	ON	N8N 5A2
240-01300	957558 ONTARIO INC		13029 TECUMSEH RD E		WINDSOR	ON	N8N 3T4
240-01210	1443122 ONTARIO LIMITED		13037 TECUMSEH RD E		WINDSOR	ON	N8N 3T4
240-01400	LACASSE MARY LOU		645 DORSET PARK		TECUMSEH	ON	N8N 3T4
240-01500	1530259 ONTARIO LIMITED		13013 TECUMSEH RD E	UNIT 1	WINDSOR	ON	N8N 2L1
230-22700	ROBERT KENNETH LAWRENCE	ROBERT JACQUELINE MARIE	850 GREEN VALLEY DR		WINDSOR	ON	N8N 3T4
230-22800	VINCENT JESS RICHARD		13028 TECUMSEH RD E		WINDSOR	ON	N8N 4N6
230-33500	COR-DEL INC		1644 ASKIN BLVD		WINDSOR	ON	N8N 3T6
230-33600	TECUMSEH BUSINESS PLAZA INC		2835 CALIFORNIA AVE		WINDSOR	ON	N9B 3S3
230-23875	SABAH GEORGES ISSA		13220 HARVEST LANE		WINDSOR	ON	N9E 3K3
240-01650	1362275 ONTARIO INC		1051 HARRISON		WINDSOR	ON	N8N 4N2
240-01660	MCDONALD'S RESTAURANTS OF TECUMSEH TOWN	CANADA LIMITED	REAL ESTATE & TAXATION DEPT	MCDONALD'S PLACE	TORONTO	ON	N9C 3J2
150-00100	TECUMSEH TOWN		917 LESPERANCE		TECUMSEH	ON	M3C 3L4
150-00200	GAUTHIER DAVID	MCMMASTER DIANE	12413 TECUMSEH RD E		WINDSOR	ON	N8N 1W9
150-00300	TRACEY SHARON ELAINE		12403 TECUMSEH RD E		WINDSOR	ON	N8N 1M6
160-00201	MC KEOWN JAMES GORDON	MC KEOWN JANE-ANNE	12409 TECUMSEH RD E		WINDSOR	ON	N8N 1M6
240-00700	BARDE HOMES LTD		12062 RIVERSIDE DR E		WINDSOR	ON	N8N 1M6
230-33700	627575 ONTARIO LTD		13266 TECUMSEH RD E		WINDSOR	ON	N8P 1A9
230-33800	PETROVEC INVESTMENTS LIMITED		13300 TECUMSEH RD		WINDSOR	ON	N8N 3T6
230-33701	537848 ONTARIO LTD		13266 TECUMSEH RD E		WINDSOR	ON	N8N 4R8
240-00100	PETRO-CANADA		2489 N.SHERIDAN WAY		WINDSOR	ON	N8N 3T6
240-00200	VIDON ENTERPRISES INC		912 HARDING ST		MISSISSAUGA	ON	L5K 1A8
240-00400	M L R GROUP INC		2835 CALIFORNIA AVE		WHITBY	ON	L1N 1Y7
240-00600	FOREST GLADE ANIMAL CLINIC	ASSOCIATES LTD	9695 TECUMSEH RD E		WINDSOR	ON	N9E 3K3
310-00300	TRANSPORT CANADA		AVIATION GROUP	4800 YONGE ST	NORTH YORK	ON	N8R 1A5
310-00400	RIOCAN HOLDINGS INC		700 LAWRENCE AVENUE WEST	SUITE 315	TORONTO	ON	M2N 6A6
260-09100	THE BUTCHER ENGINEERING	ENTERPRISES LIMITED	2755 LAUZON PARKWAY		WINDSOR	ON	M6A 3B4
							N8T 3H5

send X

send it

send it

Property Listing

8/12/2003



Handwritten notes:
 H. Donald
 H. Donald
 H. Donald
 H. Donald

RollNo	Primary Name 1	Primary Name 2	Primary Address	City	Prov	Postal
240-14300 LEGAL 1	GREEN HILLS INVESTMENTS LIMITED PLAN 12M393 BLK 99	LEGAL2	13300 TECUMSEH RD E LEGAL3	WINDSOR	ON	N8N 4R8
240-14400 LEGAL 1	CANADIAN TIRE REAL ESTATE PLAN 12M393 PT BLK 99	LIMITED LEGAL2 [RP 12R18713 PARTS 1 3 TO 14	2180 YONGE ST LEGAL3	TORONTO	ON	M4P 2V8
240-01650 LEGAL 1	FLINTSTONE AGGREGATE INC CON 2 PT LOT 156 RP 12R16249	LEGAL2 [PT 7	1611 MANNING LEGAL3	WINDSOR	ON	N8N 2L8
240-01660 LEGAL 1	MCDONALD'S RESATURANTS OF CON 2 PT LOT 156 RP 12R16249	CANADA LIMITED LEGAL2 [PTS 1.2.5 & 6	REAL ESTATE & TAXAT LEGAL3	TORONTO	ON	M3C 9L4
240-14300 LEGAL 1	GREEN HILLS INVESTMENTS LIMITED PLAN 12M393 BLK 99	LEGAL2	13300 TECUMSEH RD E LEGAL3	WINDSOR	ON	N8N 4R8
230-16400 LEGAL 1	WILLIAMSON MARLENE ELIZABETH PLAN M154 LOT 378	LEGAL2	13351 ST. GREGORY'S I LEGAL3	WINDSOR	ON	N8N 4C6
230-16500 LEGAL 1	SCHOEN MARY LOUISE PLAN M154 LOT 380	LEGAL2	600 JUNIPER COURT LEGAL3	WINDSOR	ON	N8N 4C4
230-16700 LEGAL 1	LESPERANCE ROBERT PLAN M154 LOT 381	LESPERANCE JEANNETTE LEGAL2	610 JUNIPER CRT LEGAL3	WINDSOR	ON	N8N 4C5
230-16800 LEGAL 1	DEMERS CHAD JUSTIN PLAN M154 LOT 382	PARKER LINDA ELIZABETH LEGAL2	620 JUNIPER CRT LEGAL3	WINDSOR	ON	N8N 4C5
230-16900 LEGAL 1	TOKAI RIKI CO LTD PLAN M154 LOT 383	LEGAL2	255 PATILLO RD LEGAL3	WINDSOR	ON	N8N 2L9

Property Listing

8/12/2003



RollNo	Primary Name 1	Primary Name 2	Primary Address	City	Prov	Postal
238-17600 LEGAL 1	VANDER KOOY SHIRLEY ARLINE PLAN M154 LOT 385		650 JUNIPER CRT LEGAL 3	WINDSOR	ON	N8N 4C5
238-17600 LEGAL 1	BUSHEY GREGORY CARL PLAN M154 LOT 384	BUSHEY FRANCES JACQUELINE	640 JUNIPER CRT LEGAL 3	WINDSOR	ON	N8N 4C5
240-00700 LEGAL 1	BARDE HOMES LTD CON 2 PT LOT 156		12062 RIVERSIDE DR E LEGAL 3	WINDSOR	ON	N8P 1A9
238-33300 LEGAL 1	PETROVEC INVESTMENTS LIMITED CON 1 PT LOT 156	RP 12R1561 PARTS 4 TO 6	13300 TECUMSEH RD LEGAL 3	WINDSOR	ON	N8N 4R8
240-00100 LEGAL 1	PETRO-CANADA CON 2 PT LOT 156	RP 12R13765 PARTS 1 2 6 7 8	2489 N.SHERIDAN WAY LEGAL 3	MISSISSAUGA	ON	L5K 1A8
310-00500 LEGAL 1	IPCF PROPERTIES INC. CON WPC PT LOT 1	RP 12R14186 PART 2	2ND FLOOR LEGAL 3	TORONTO	ON	M4T 2S3
310-00300 LEGAL 1	TRANSPORT CANADA CON WPC PT LOT 1	LESS 12R14771 PT 2	AVIATION GROUP LEGAL 3	NORTH YORK	ON	M2N 6A6
310-00400 LEGAL 1	RIOCAN HOLDINGS INC CON WPC PT LOT 1	RP 12R14186 PART 1	700 LAWRENCE AVENUE LEGAL 3	TORONTO	ON	M5A 3B4
260-09100 LEGAL 1	THE BUTCHER ENGINEERING CON WPC PT LOT 1 PT LOT 2	ENTERPRISES LIMITED RP 12R9874 PART 1	LIFESTYLE FAMILY FITNESS CENTRE INC. 2755 LAUZON PARKWAY LEGAL 3	WINDSOR	ON	N8T 3H5
260-09200 LEGAL 1	TECUMSEH TOWN CON WPC PT FARM LOT 2	PLAN M133 BLK IX	917 LESPERANCE LEGAL 3	TECUMSEH	ON	N8N 1W9

St. Clair Ave E
 22
 I
 Decker
 *
 13275 Tecumseh Ave.
 N8N 3T4
 ✓

Property Listing

8/12/2003



RollNo	Primary Name 1	Primary Name 2	Primary Address	City	Prov	Postal
570-48380 LEGAL1	JAMES SYLVESTRE ENTERPRISES CON 1 PT LOT 156	LTD RP 12R11928 PT 3 RP 12R16096	RR 1 STN TECUMSEH LEGAL3 [PTS 4 5 6 10 11 & 12]	WINDSOR	ON	N8N 2L9
570-47900 LEGAL1	1461791 ONTARIO LTD CON 2 PT LOTS 155 & 156	LEGAL2 RP 12R10051 PARTS 3 TO 12	1715 MANNING RD LEGAL3 [17 TO 26]	WINDSOR	ON	N8N 2M3
570-48000 LEGAL1	593116 ONTARIO INC CON 2 PT LOTS 155 & 156	LEGAL2 RP 12R2627 PT PART 2	RR 2 STN TECUMSEH LEGAL3	WINDSOR	ON	N8N 2M1
570-47905 LEGAL1	851312 ONTARIO LTD CON 2 PT LOT 156	LEGAL2 RP 12R10047 PTS 1 & 2	300 EUGENIE ST E LEGAL3	WINDSOR	ON	N8X 2Y1
570-48200 LEGAL1	MARION MARY EDNA BERNICE CON 2 PT LOT 156	LEGAL2 RP 12R8134 PART 1	RR 1 STN TECUMSEH LEGAL3	WINDSOR	ON	N8N 2L9
570-48300 LEGAL1	JAMES SYLVESTRE DEVELOPMENT CON 1 PT LOT 156	LTD RP 12R13139 PARTS 1 TO 4	1865 MANNING ROAD LEGAL3	WINDSOR	ON	N8N 2L9
570-48350 LEGAL1	MANNING RD BLDG CENTRE LTD CON 1 PT LOT 156	LEGAL2 RP 12R11928 PARTS 1 2 4	RR 1 STN TECUMSEH LEGAL3 [RP 12R16096 PTS 1 2 3 7 8 9]	WINDSOR	ON	N8N 2L9
570-48100 LEGAL1	JAMES SYLVESTRE DEVELOPMENT CON 2 PT LOTS 155 & 156	LTD RP 12R14005 PTS 47 49 TO 53	1865 MANNING ROAD LEGAL3	WINDSOR	ON	N8N 2L9
570-48400 LEGAL1	905388 ONTARIO LTD CON 2 PT LOTS 155 & 156	LEGAL2 RP 12R9571 PART 1	13480 SYLVESTRE DR LEGAL3	WINDSOR	ON	N8N 2L9
570-48005 LEGAL1	1403440 ONTARIO INC CON 1 PT LOT 156	LEGAL2 RP 12R18001 PARTS 1 TO 9	1825 MANNING RD LEGAL3	WINDSOR	ON	N8N 2L9

Property Listing

8/12/2003



RollNo	Primary Name 1	Primary Name 2	Primary Address	City	Prov	Postal
570-48460 LEGAL1 [CON 1 PT LOT 156]	LUTHERAN CHURCH - CANADA LEGAL2 [RP 12R12938 PARTS 7 & 10]	EAST DISTRICT	275 LAWRENCE AVE CIVIC W/S MANNING RD	KITCHENER	ON	N2M 1Y3 Frontage 150.63 Acreage 2.88
570-47900 LEGAL1 [CON 2 PT LOTS 155 & 156]	1461791 ONTARIO LTD LEGAL2 [RP 12R10051 PARTS 3 TO 12]		1715 MANNING RD RD#16 1715 MANNING RD	WINDSOR	ON	N8N 2M3 Frontage 236.89 Acreage 6.22
570-48000 LEGAL1 [CON 2 PT LOTS 155 & 156]	593116 ONTARIO INC LEGAL2 [RP 12R9267 PT PART 2]		RR 2 STN TECUMSEH CIVIC 1745 MANNING RD	WINDSOR	ON	N8N 2M1 Frontage 297.34 Acreage 8.84
570-47905 LEGAL1 [CON 2 PT LOT 156]	851312 ONTARIO LTD LEGAL2 [RP 12R10047 PTS 1 & 2]		300 EUGENIE ST E CIVIC 13425 DESRO DR	WINDSOR	ON	N8X 2Y1 Frontage 165.83 Acreage 1.75
570-48200 LEGAL1 [CON 2 PT LOT 156]	MARION MARY EDNA BERNICE LEGAL2 [RP 12R8134 PART 1]	MARION DANIEL AUREL	RR 1 STN TECUMSEH CIVIC 1845 MANNING RD	WINDSOR	ON	N8N 2L9 Frontage 120.00 Acreage 0.00
570-48300 LEGAL1 [CON 1 PT LOT 156]	JAMES SYLVESTRE DEVELOPMENT LTD LEGAL2 [RP 12R13139 PARTS 1 TO 4]		1865 MANNING ROAD CIVIC 1847 MANNING RD	WINDSOR	ON	N8N 2L9 Frontage 89.33 Acreage 4.14
570-48350 LEGAL1 [CON 1 PT LOT 156]	MANNING RD BLDG CENTRE LTD LEGAL2 [RP 12R11928 PARTS 1 2 4]		RR 1 STN TECUMSEH CIVIC 1855 MANNING RD	WINDSOR	ON	N8N 2L9 Frontage 0.00 Acreage 3.83
570-48100 LEGAL1 [CON 2 PT LOTS 155 & 156]	JAMES SYLVESTRE DEVELOPMENT LTD LEGAL2 [RP 12R14005 PTS 47 49 TO 53]		1865 MANNING ROAD CIVIC W/S MANNING RD	WINDSOR	ON	N8N 2L9 Frontage 0.00 Acreage 8.89
570-48400 LEGAL1 [CON 2 PT LOTS 155 & 156]	905388 ONTARIO LTD LEGAL2 [RP 12R9571 PART 1]		13480 SYLVESTRE DR CIVIC 13480 SYLVESTRE DR	WINDSOR	ON	N8N 2L9 Frontage 350.39 Acreage 1.45
570-48430 LEGAL1 [CON 2 PT LOTS 155 & 156]	JAMES SYLVESTRE DEVELOPMENT LTD LEGAL2 [RP 12R11362 PARTS 1 TO 3]		1865 MANNING ROAD CIVIC 13485 SYLVESTRE DR	WINDSOR	ON	N8N 2L9 Frontage 243.00 Acreage 0.00



Property Listing

8/12/2003



Handwritten signature or initials, possibly 'N9N'.

RollNo	Primary Name 1	Primary Name 2	Primary Address	City	Prov	Postal
570-48470	SYLVESTER JEANNETTE		RR 1 STN TECUMSEH	WINDSOR	ON	N9N 2L9
	LEGAL1 [CON 3 PT LOT 156]	LEGAL2 [RP 12R14315 PTS 4 TO 7]	FRONTAGE W/S MANNING RD	FRONTAGE 0.00	ACREAGE	2.75
570-48005	1403440 ONTARIO INC		1825 MANNING RD	WINDSOR	ON	N6N 2L9
	LEGAL1 [CON 1 PT LOT 156]	LEGAL2 [RP 12R16001 PARTS 1 TO 9]	FRONTAGE N/S JAMSYL DR	FRONTAGE 238.19	ACREAGE	2.22

R. LUCENTE ENGINEERING INC. CONSULTING ENGINEERS

3514 Walker Road, Unit 1
Windsor, Ontario N8W 3S4

Phone: (519) 966-4008
Fax: (519) 966-4088
email: rlucente@bellnet.ca

January 12, 2004

Our File No. 02-829

Corporation of the County of Essex
Office of the County Engineer
360 Fairview Avenue West
Windsor, Ontario
N8M 1Y6

Attention: Mr. Richard Fazecash, P. Eng.
Assistant Roads Engineer

Dear Sir:

Re: Notification List for Manning Road Class E.A.

We are forwarding to you our contact list for the Manning Road Class E.A. You may add to or delete from this list and return immediately in order that we can send out the notices. The first P.I.C. will be held on Wednesday January 21, 2004.

If you have any questions, please contact the undersigned.

Yours truly,

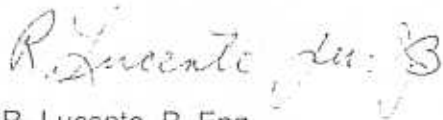

R. Lucente, P. Eng.

RL:jb

Enclosure

(letters\tecumseh\ManningEA-CorpOFE-Fazecash.doc)

R. LUCENTE ENGINEERING INC.

CONSULTING ENGINEERS

3514 Walker Road, Unit 1
Windsor, Ontario N8W 3S4

Phone: (519) 966-4008
Fax: (519) 966-4088
email: rlucente@bellnet.ca

January 13, 2004

Our File No. 02-829

Windsor-Essex County Health Unit
~~962 Goyeau Street~~
Windsor, Ontario N9A 1H8

1005 Ouellette Avenue
N9A 4J8
Rob Lyons

Attention: Director of Community Health Inspection

Dear Sir:

Re: Class Environmental Assessment (Class EA)
County Road No. 19 (Manning Road) from
St. Gregory's Road to Sylvestre Drive

This is to advise you that the County of Essex with the co-operation of the Town of Tecumseh and Town of Lakeshore is presently undertaking an Environmental Assessment Study for the improvement of County Road No. 19 (Manning Road) from St. Gregory's Road to Sylvestre Drive.

In order to obtain input from the general public, a Public Information Centre has been scheduled for Wednesday, January 21, 2004. Please refer to the newspaper advertisement (*copy attached*) for further details.

Should you or anyone else in your agency or department have an interest in this project, we would urge you to attend the Information Centre or contact the undersigned with your comments and/or questions.

Yours truly,

R. Lucente, P.Eng.

RL:lb

Enclosure

C: Mr. T. Bateman, P.Eng., County Engineer - The Corporation of the County of Essex
Mr. L. Beaudoin, Director of Public Works - The Corporation of the Town of Tecumseh
Mr. T. Mousseau, Director of Public Works - Corporation of the Town of Lakeshore

(letters\manningPIC1agencies.doc)

R. LUCENTE ENGINEERING INC.

CONSULTING ENGINEERS

3514 Walker Road, Unit 1
Windsor, Ontario N8W 3S4

Phone: (519) 966-4008
Fax: (519) 966-4088
email: rlucente@bellnet.ca

January 15, 2004

DEAR PROPERTY OWNERS AND BUSINESS MERCHANTS

The County of Essex has initiated a study to identify the traffic problems presently being experienced on County Road No. 19 (Manning Road) from St. Gregory's Road to Sylvestre Drive. The study is following the requirements for Schedule 'C' projects of the Municipal Class Environmental Assessment (Class E.A.) as prepared by the Municipal Engineers Association, June 2000.

This Class E.A. is being undertaken by R. Lucente Engineering Inc. on behalf of the County of Essex in co-operation with the Town of Tecumseh and the Town of Lakeshore. The purpose of the study is to confirm the transportation problems and to identify and evaluate alternatives which will address those problems.

A Notice of Commencement and Public Information Centre #1 (P.I.C. #1) was recently published in The Windsor Star, The Essex Free Press and The Tecumseh Tribune. The purpose of the first P.I.C. is to review the study process, describe the background studies that have identified the need for improvements and to obtain input from the public and agencies regarding concerns or issues related to the study. We are inviting you to participate in our upcoming P.I.C. #1. If you are not the Owner, we would appreciate you forwarding this information to the Owner.

The time and location for the P.I.C. are as follows:

DATE: Wednesday, January 21, 2004
TIME: 3:00 p.m. to 8:00 p.m., E.S.T.
LOCATION: Tecumseh Arena, 12021 McNorton Street

If you are unable to attend the P.I.C., we would request that you submit any comments or questions to the undersigned by Wednesday, February 4, 2004:

R. Lucente, P. Eng.
R. Lucente Engineering Inc.
3514 Walker Road, Unit No. 1
Windsor, Ontario N8W 3S4

Telephone: 966-4008
Fax: 966-4088
e-mail: rlucente@bellnet.ca

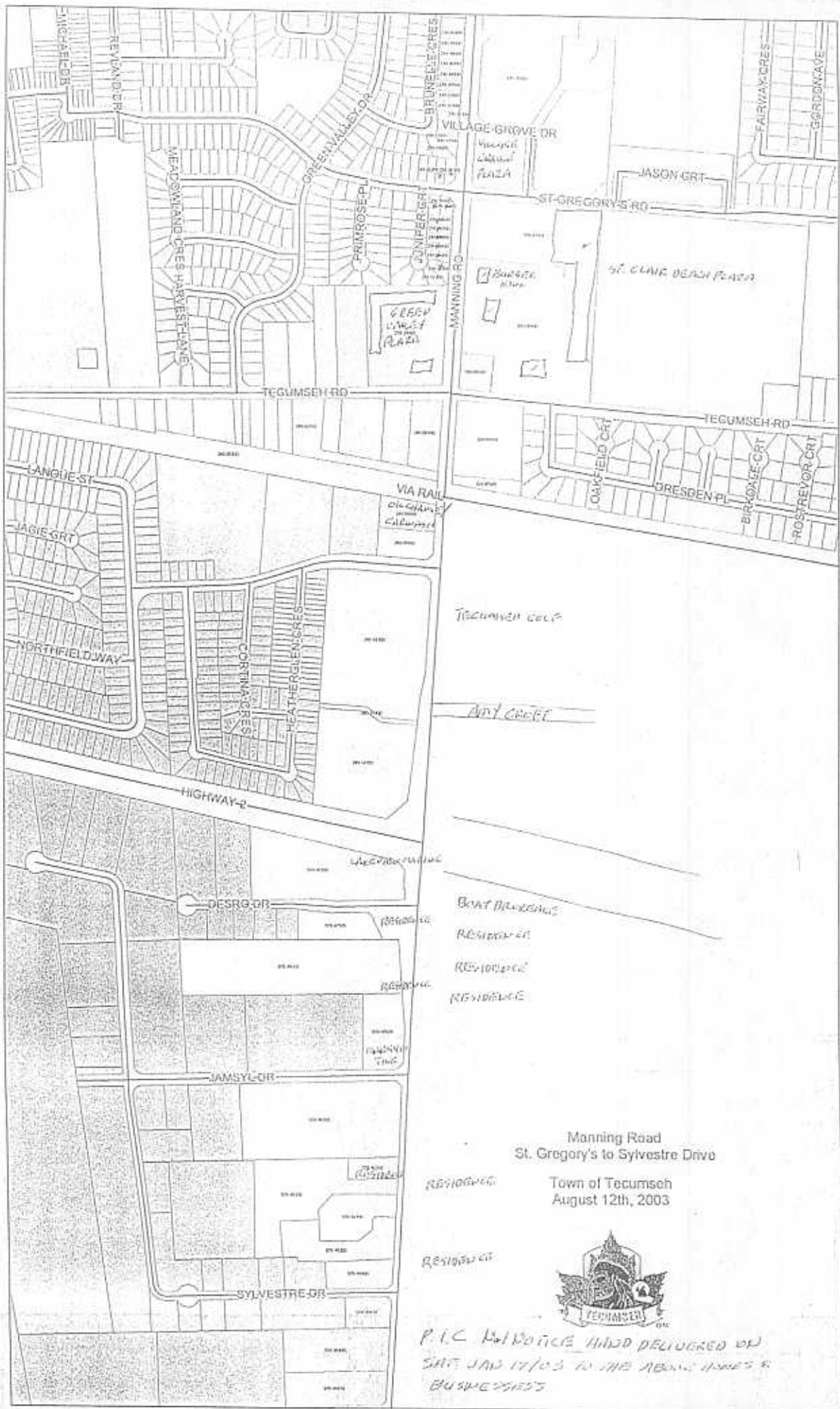

Manning Road
 St. Gregory's to Sylvestre Drive
 Town of Tecumseh
 August 12th, 2003



P.L.C. Map Notice Also Delivered by
 SAJ JAW 11/03 to the Above Names &
 BUSINESSES



**THE CORPORATION OF THE COUNTY OF ESSEX
CLASS ENVIRONMENTAL ASSESSMENT
MANNING ROAD (COUNTY RD. NO. 19)
FROM ST. GREGORY'S ROAD TO SYLVESTRE DRIVE
NOTICE OF STUDY COMMENCEMENT
AND PUBLIC INFORMATION CENTRE**

The County of Essex has commenced a study to identify the traffic problems presently being experienced on County Rd. No. 19 (Manning Road) from St. Gregory's Road to Sylvestre Drive. The study is being conducted in accordance with the requirements for Schedule 'C' projects of the Municipal Class Environmental Assessment as prepared by the Municipal Engineers Association, June 2000.

The County is making preliminary study material and plans available for public review at a Public Information Centre (P.I.C.) on Wednesday, January 21, 2004 at the Tecumseh Arena located at 12021 McNorton from 3:00 p.m., E.S.T. to 8:00 p.m., E.S.T.

The purpose of this P.I.C. is to review the study process, describe the background studies that have identified the need for improvements, and to obtain input from the public regarding concerns or issues related to the study. The consultants will accept input and comments until February 6, 2004.

The map shows the approximate limits of the study and location for the P.I.C.

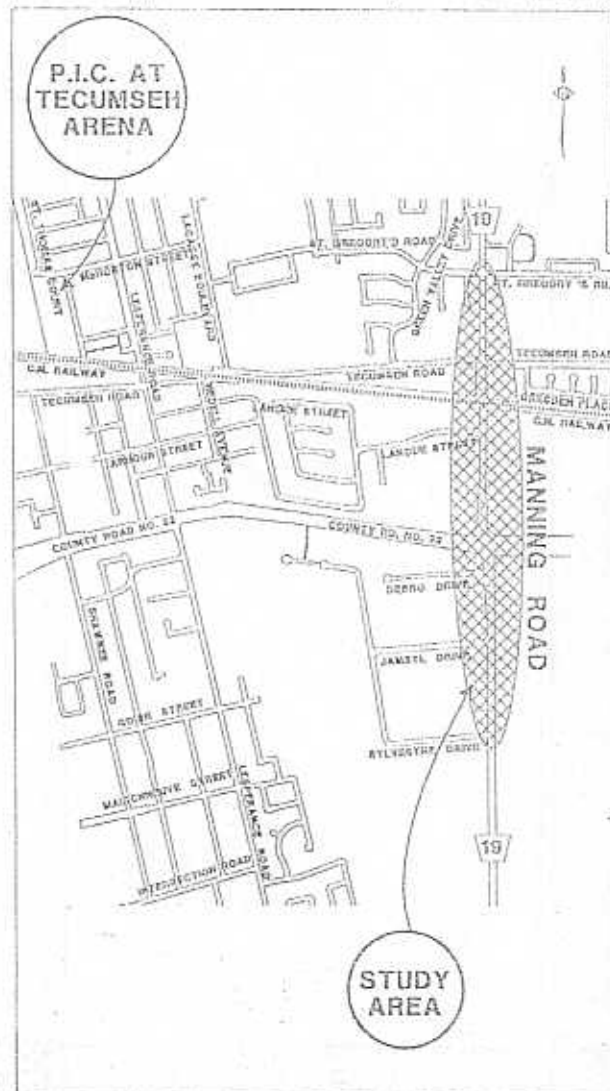

Information or questions may be submitted to the following individuals:

Mr. T. Bateman, P. Eng., County Engineer
The Corporation of the County of Essex
350 Fairview Avenue West
Essex, Ontario N8M 1Y6
Phone: (519) 776-6441
Fax: (519) 776-4455
Email: tbateman@countyofoessex.on.ca

Mr. R. Lucente, P. Eng.
R. Lucente Engineering Inc.
3514 Walker Road, Unit #1
Windsor, Ontario N8W 3S4
Phone: (519) 966-4008
Fax: (519) 966-4088
Email: rlucente@bellnet.ca

This notice issued January 6, 2004.

Rocco's

R. LUCENTE ENGINEERING INC.

CONSULTING ENGINEERS

3514 Walker Road, Unit 1
Windsor, Ontario N8W 3S4

Phone: (519) 966-4008
Fax: (519) 966-4088
email: rlucente@bellnet.ca

January 13, 2004

Our File No. 02-829

Lakeshore O.P.P.
875 Notre Dame
Belle River, Ontario N0R 1A0

Attention: Sgt. Mike Dmytrow

Dear Sir:

**Re: Class Environmental Assessment (Class EA)
County Road No. 19 (Manning Road) from
St. Gregory's Road to Sylvestre Drive**

This is to advise you that the County of Essex with the co-operation of the Town of Tecumseh and Town of Lakeshore is presently undertaking an Environmental Assessment Study for the improvement of County Road No. 19 (Manning Road) from St. Gregory's Road to Sylvestre Drive.

In order to obtain input from the general public, a Public Information Centre has been scheduled for Wednesday, January 21, 2004. Please refer to the newspaper advertisement (*copy attached*) for further details.

Should you or anyone else in your agency or department have an interest in this project, we would urge you to attend the Information Centre or contact the undersigned with your comments and/or questions.

Yours truly,

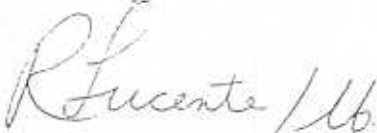

R. Lucente, P.Eng.

RL:lb

Enclosure

C: Mr. T. Bateman, P.Eng., County Engineer - The Corporation of the County of Essex
Mr. L. Beaudoin, Director of Public Works - The Corporation of the Town of Tecumseh
Mr. T. Mousseau, Director of Public Works - Corporation of the Town of Lakeshore

(letters\manningPIC1agencies.doc)

R. LUCENTE ENGINEERING INC.

CONSULTING ENGINEERS

3514 Walker Road, Unit 1
Windsor, Ontario N8W 3S4

Phone: (519) 966-4008
Fax: (519) 966-4088
email: rlucente@bellnet.ca

January 13, 2004

Our File No. 02-829

Corporation of the Town of Lakeshore
419 Notre Dame
Belle River, Ontario N0R 1A0

Attention: Mr. D. Perdu, C.A.O.

Dear Sir:

**Re: Class Environmental Assessment (Class EA)
County Road No. 19 (Manning Road) from
St. Gregory's Road to Sylvestre Drive**

This is to advise you that the County of Essex with the co-operation of the Town of Tecumseh and Town of Lakeshore is presently undertaking an Environmental Assessment Study for the improvement of County Road No. 19 (Manning Road) from St. Gregory's Road to Sylvestre Drive.

In order to obtain input from the general public, a Public Information Centre has been scheduled for Wednesday, January 21, 2004. Please refer to the newspaper advertisement (*copy attached*) for further details.

We ask that you inform all Councillors for the Town of this P.I.C. and provide them with a copy of the advertisement. In addition, should you or anyone else in your department have an interest in this project, we would urge you to attend the Information Centre or contact the undersigned with your comments and/or questions.

Yours truly,

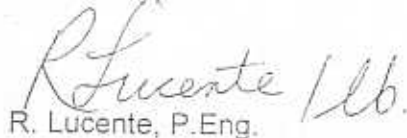
R. Lucente, P.Eng.

RL:lb

Enclosure

C: Mr. T. Bateman, P.Eng., County Engineer - The Corporation of the County of Essex
Mr. L. Beaudoin, Director of Public Works - The Corporation of the Town of Tecumseh
Mr. T. Mousseau, Director of Public Works - Corporation of the Town of Lakeshore

(letters\manningPIC1agencies.doc)

R. LUCENTE ENGINEERING INC.

CONSULTING ENGINEERS

3514 Walker Road, Unit 1
Windsor, Ontario N8W 3S4

Phone: (519) 966-4008
Fax: (519) 966-4088
email: rlucente@bellnet.ca

January 13, 2004

Our File No. 02-829

Corporation of the County of Essex
Office of the County Engineer
360 Fairview Avenue West
Essex, Ontario
N8M 1Y6

Attention: Mr. T. Bateman, P. Eng.
County Engineer

Dear Sir:

Re: Class Environmental Assessment (Class EA)
County Road No. 19 (Manning Road) from
St. Gregory's Road to Sylvestre Drive

Enclosed please find a copy of our correspondence and the list of various agencies contacted regarding Public Information Centre No. 1 to be held on Wednesday, January 21, 2004. Please note that you were "copied" on all letters forwarded.

Yours truly,



Lorraine Bortolin

/lb

Enclosures

(letters\tecumseh\manningEAcopied.doc)

R. LUCENTE ENGINEERING INC. CONSULTING ENGINEERS

3514 Walker Road, Unit 1
Windsor, Ontario N8W 3S4

Phone: (519) 966-4008
Fax: (519) 966-4088
email: rlucente@bellnet.ca

January 13, 2004

Our File No. 02-829

Corporation of the Town of Tecumseh
1189 Lacasse Boulevard
Tecumseh, Ontario
N8N 2C7

Attention: Mr. L. Beaudoin,
Director of Public Works

Dear Sir:

Re: Class Environmental Assessment (Class EA)
County Road No. 19 (Manning Road) from
St. Gregory's Road to Sylvestre Drive

Enclosed please find a copy of our correspondence and the list of various agencies contacted regarding Public Information Centre No. 1 to be held on Wednesday, January 21, 2004. Please note that you were "copied" on all letters forwarded.

Yours truly,



Lorraine Bortolin

/lb

Enclosures

(letters\tecumseh\manningEAcopied.doc)

R. LUCENTE ENGINEERING INC.

CONSULTING ENGINEERS

3514 Walker Road, Unit 1
Windsor, Ontario N8W 3S4

Phone: (519) 966-4008
Fax: (519) 966-4088
email: rlucente@bellnet.ca

January 13, 2004

Our File No. 02-829

Corporation of the Town of Lakeshore
419 Notre Dame
Belle River, Ontario
NOR 1A0

Attention: Mr. T. Mousseau,
Director of Public Works

Dear Sir:

Re: Class Environmental Assessment (Class EA)
County Road No. 19 (Manning Road) from
St. Gregory's Road to Sylvestre Drive

Enclosed please find a copy of our correspondence and the list of various agencies contacted regarding Public Information Centre No. 1 to be held on Wednesday, January 21, 2004. Please note that you were "copied" on all letters forwarded.

Yours truly,

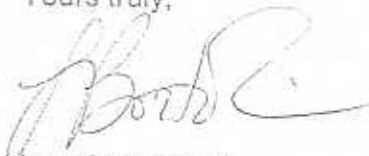

Lorraine Bortolin

/lb

Enclosures

(letters\tecumseh\manningEAcopied.doc)

CONTACT LIST FOR MANNING ROAD E.A.

Corporation of the Town of Tecumseh
Fire Department
917 Lesperance Road
Tecumseh, Ontario N8N 1W9

Attention: ~~Mr. Randy Coeile, Fire Chief~~

Corporation of the Town of Tecumseh
917 Lesperance Road
Tecumseh, Ontario N8N 1W9

Attention: ~~Mr. G. Sykes, C.A.O.~~

Corporation of the Town of Tecumseh
1189 Lacasse Boulevard
Tecumseh, Ontario N8N 2C7

Attention: ~~Mr. R. Filipov, Director of Water~~

Corporation of the Town of Tecumseh
917 Lesperance Road
Tecumseh, Ontario N8N 1W9

Attention: Mr. B. Hillman, Director of
Planning

Tecumseh O.P.P.
963 Lesperance Road
Tecumseh, Ontario N8N 1W9

Attention: Sgt. David Strang

Tecumseh B.I.A.
917 Lesperance Road
Tecumseh, Ontario N8N 1W9

Attention: Ms. Rose MacLachlan, Director
of Communications & Development

Student Transportation Services
360 Fairview Avenue West, Suite 112
Essex, Ontario N8M 3G4

Attention: Mr. Frank Vergunst OR
Mr. Lorne Sauve

Essex Region Conservation Authority
360 Fairview Avenue West
Essex, Ontario N8M 1Y6

Attention: Mr. Stan Taylor, P.Eng.
Water Management Supervisor

Essex Powerlines Corporation
360 Fairview Avenue West
Essex, Ontario N8M 1Y6

Attention: Mr. Jerry Martin,
Operations Manager

Corporation of the County of Essex
Planning Department
360 Fairview Avenue West
Essex, Ontario N8M 1Y6

Attention: Mr. Bill King, Manager of
Planning Services

Windsor Essex-County Active Living
Coalition
360 Fairview Avenue West, Suite 215
Essex, Ontario N8M 3G4

Attention: Ms. Robin Cooper

CN Rail
1 Administration Road
Concord, Ontario L4K 1B9

Attention: Mr. John MacTaggart,
Public Works Engineer

VIA Rail (2 separate letters)
50 Drummond Street, Unit C
Toronto, Ontario M8V 4B5

Attention: Mr. Kenneth Rose, Director
Real Estate S/W Ontario

Attention: Mr. John Walsh, Senior Officer
Technical Services

VIA Rail Canada Inc.
298 Walker Road
Windsor, Ontario N8Y 2M9

Attention: Mr. Ron Doherty, Manager

Corporation of the City of Windsor
Infrastructure Services
1266 McDougall Avenue
Windsor, Ontario N8X 3N7

Attention: Mr. John Tofflemire, P.Eng.,
City Engineer

Bell Canada
1149 Goyeau Street, P. O. Box 1601
Windsor, Ontario N9A 6R8

Attention: Ms. Janine Mailloux

Cogeco Cable Solutions
2525 Dougall Avenue
Windsor, Ontario N8X 5A7

Attention: Mr. Steve Meser

Union Gas Limited
Windsor Administrative Office
650 Division Road
Windsor, Ontario N9A 6N7

Attention: Mr. Scott Walker,
Service Manager

Windsor Bicycling Committee
c/o 961 Watson Avenue
Windsor, Ontario N8S 3T1

Attention: Mr. James Sommerdyk

Windsor-Essex Catholic District School
Board
385 Cameron Avenue
Windsor, Ontario N9B 1Y8

Attention: Mr. Michael Moher,
Director of Education

Greater Essex County District School Board
451 Park Street West
Windsor, Ontario N9A 6K1

Attention: Ms. Mary Jean Gallagher,
Director of Education

Conseil Scolaire de District Des Ecoles
Catholiques due Sud Ouest
7515 Forest Glade Drive
Windsor, Ontario N8T 3P5

Attention: Mssr. Michel Serré,
Director of Education

Ministry of the Environment
4510 Rhodes Drive
Windsor, Ontario N8W 5K5

Attention: Mr. Kim Ferguson, P.Eng.

Windsor-Essex County Health Unit
962 Goyeau Street
Windsor, Ontario N9A 1H8

Attention: Director of Community Health
Inspection

Citizens Environmental Alliance
275 Oak Avenue
Windsor, Ontario N9A 5E5

Attention: Mr. D. Coronado

Environmental Awareness Association
c/o SAC, CAW Student Centre
University of Windsor
401 Sunset Avenue
Windsor, Ontario N9B 3P4

Sun Parlour Emergencies Incorporated
46 Seacliffe Drive West
Leamington, Ontario N8H 3X9

Attention: Mr. Ed Jacobs, Manager

Ministry of the Environment
733 Exeter Road
London, Ontario N6E 1L3

Attention: Mr. Ron Griffiths, Environmental
Assessment Co-ordinator

Ministry of Transportation
659 Exeter Road
London, Ontario N6E 1L3

Attention: Mr. Ken Teasdale
and/or Mr. Andy Boldt
Regional Operations Officers

Ministry of Culture, Heritage Operations
55 Centre Street
London, Ontario N6J 1T4

Attention: Mr. Neal Ferris, Heritage Planner

Ministry of Municipal Affairs and Housing
Community Planning and Development
659 Exeter Road, 2nd Floor
London, Ontario N6E 1L3

Attention: Mr. Bruce Curtis, Manager

Hydro One Networks Inc.
483 Bay Street, 12th Floor
Toronto, Ontario M5G 2P5

Attention: Mr. Paul Dockrill

Fire Department Administration
592 St. Charles Street
Belle River, Ontario N0R 1A0

Attention: Mr. D. Spry, Fire Chief

The Corporation of the Town of Lakeshore
419 Notre Dame
Belle River, Ontario N0R 1A0

Attention: Mr. Daniel Perdu,
Chief Administrative Officer

The Corporation of the Town of Lakeshore
419 Notre Dame
Belle River, Ontario N0R 1A0

Attention: Ms. Cindy Prince,
Municipal Planner

Lakeshore O.P.P.
875 Notre Dame
Belle River, Ontario N0R 1A0

Attention: Sgt. Mike Dmytrow

Ministry of Transportation
Environmental Services Unit
1201 Wilson Avenue,
3rd Floor, Atrium Tower
Downsview, Ontario M3M 1J8

Attention: Ms. Barbara Brownlee,
Special Projects Co-ordinator

Ministry of Natural Resources
1023 Richmond Street West
Chatham, Ontario N7M 5J5

Attention: Mr. Ken Yaraskavitch, Supervisor

NAV Canada
2530 Blair Boulevard
London, Ontario

Attention: Mr. Ron Humphrey,
Technical Supervisor

Mr. J. Comartin, MP
Windsor-St. Clair
1304-B Lauzon Road
Windsor, Ontario N8S 3N1

Mr. Dwight Duncan, M.P.P.
Windsor-St. Clair
4808 Tecumseh Road East
Windsor, Ontario N8T 1B8

Transport Canada, Surface
20 Toronto Street, Suite 600
Toronto, Ontario M5C 2B8

Attention: Mr. Doug Vollick, Senior Signal
Systems Officer

(miscellaneous/contactmanningEA.doc)

**TOWN OF LAKESHORE
NOTICE OF PUBLIC MEETING**

AMENDMENT TO DEVELOPMENT CHARGES BY-LAW

TAKE NOTICE that, in accordance with clause 12 (1) (b) of the Development Charges Act, the Council of the Corporation of the Town of Lakeshore will hold a public meeting in the Council Chambers at the Municipal Building to consider a background report and accompanying draft amendment to the Development Charges By-law on Monday, April 26th, at 7:30 p.m.

The purpose of the meeting is to consider an amendment to the existing Development Charges By-law to introduce two new components to the current charge. The first component to be added is a \$9,000 per unit charge for those new dwellings within the service area of the new Belle River Water Treatment Plant. The second charge is area specific and pertains to lands on the south side of County Road 22, east of Manning Road. This charge is specific to the development area only and is required in response to works that have been provided by the developer to the north. This charge is required as part of a front end financing arrangement.

The money collected through these new charges will be used to offset the cost of providing the services required to accommodate growth. Reports on each of the two projects have been completed and are available for review.

This is an amendment to the existing Development Charges By-law only. A review of the entire by-law will be undertaken by the Town later this year. This amendment is in response to two specific projects that have recently received municipal approval.

ANY PERSON may attend the meetings and/or make written or verbal representation either in support of or in opposition to the proposed amendment to the Development Charges By-law.

ADDITIONAL INFORMATION relating to this matter, including a copy of the relevant reports, are available for review at the Municipal Office for the Corporation of the Town of Lakeshore, 419 Notre Dame Street, Belle River between 9:00 a.m. and 4:30 p.m.

DATED AT THE TOWN OF LAKESHORE THIS 5TH DAY OF APRIL, 2004.

ANDREA RIVEST, CLERK
TOWN OF LAKESHORE
419 NOTRE DAME STREET
BELLE RIVER, ONTARIO NOR 1A0
TELEPHONE: 728-2700

KEY MAP

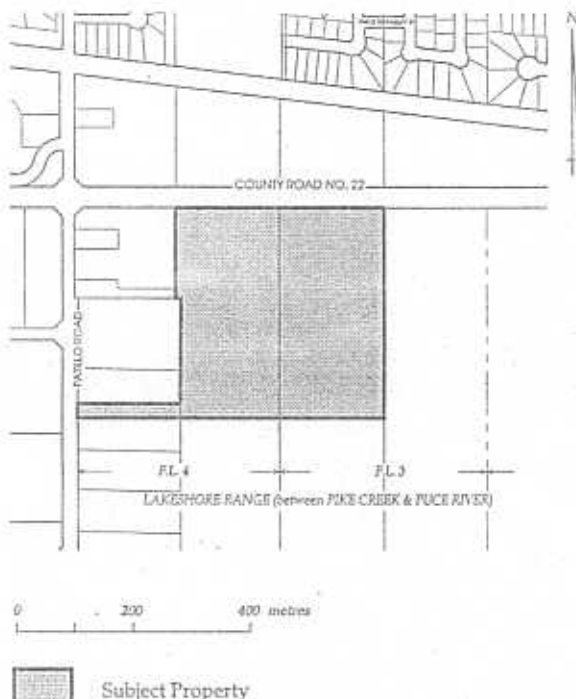

**FORM 1
THE PLANNING ACT, R.S.O. 1990
NOTICE OF THE PASSING OF AN OFFICIAL PLAN
AND ZONING BY-LAW AMENDMENT BY
THE CORPORATION OF THE TOWN OF LAKESHORE**

TAKE NOTICE that the Council of the Corporation of the Town of Lakeshore has passed By-law 27-2004 and 28-2004 on the 22nd day of March, 2004 under Sections 17 and 34 of the Planning Act, R.S.O. 1990. By-law 27-2004 adopted an amendment to the Official Plan pertaining to lands within the former Township of Maidstone. The Official Plan Amendment requires the approval of the Provincial Ministry of Municipal Affairs and Housing as the approval authority. The Official Plan Amendment and Zoning By-law Amendment only come into effect if that approval is provided.

AND TAKE NOTICE that any person or public body will be entitled to receive notice of the decision pertaining to the Official Plan Amendment if a written request to be notified is made to the approval authority. If you wish to be notified of the decision, you must make a written request to the Ministry of Municipal Affairs and Housing, c/o Municipal Services Office - Southwestern, 659 Exeter Road, 2nd Floor, London, Ontario N6E 1L5, telephone (519) 873-4020 or toll free (800) 265-4736.

AND TAKE NOTICE that only individuals, corporations and public bodies may appeal a zoning by-law to the Ontario Municipal Board. A notice of appeal may not be filed by an unincorporated association or group. However, a notice of appeal may be filed in the name of an individual who is a member of the association or the group on its behalf. An appeal to the Ontario Municipal Board in respect of the by-law may be completed by filing with the Clerk of the Corporation of the Town of Lakeshore not later than the 25th day of April, 2004 a notice of appeal setting out the objection to the by-law and the reasons in support of the objection accompanied by the required fee of \$125 made payable to the Minister of Finance.

An explanation of the purpose and effect of the Official Plan Amendment and Zoning By-law Amendment, describing the lands to which the by-law applies, and a key map showing the location of the lands to which the by-law applies are attached. The complete by-law and any associated information are available for inspection in my office during regular office hours.

DATED at the Town of Lakeshore this 5th day of April, 2004.

ANDREA RIVEST, CLERK
TOWN OF LAKESHORE
419 NOTRE DAME STREET
BELLE RIVER, ONTARIO NOR 1A0
TELEPHONE: (519) 728-2700

EXPLANATORY NOTE

The purpose of By-law 27-2004 is to adopt an Official Plan Amendment which will permit the construction of a new secondary school on Part of Lots 3 and 4, Lakeshore Range Between Pucelle Creek and Puce River, Geographic Township of Maidstone, now in the Town of Lakeshore, County of Essex, Ontario (see Key Map below for location).

The purpose of By-law 28-2004 is to change the zoning on the same property from Agricultural to Institutional Holding to permit the construction of the school facility. Development of the school facility cannot commence until the holding classification is removed by Council by-law. The holding classification will not be removed until all details pertaining to on-site and off-site servicing and shared use arrangements are finalized. All development of the subject property will be subject to site plan control.

SCHEDULE "A"
TOWNSHIP OF MAIDSTONE
LAND USE PLAN

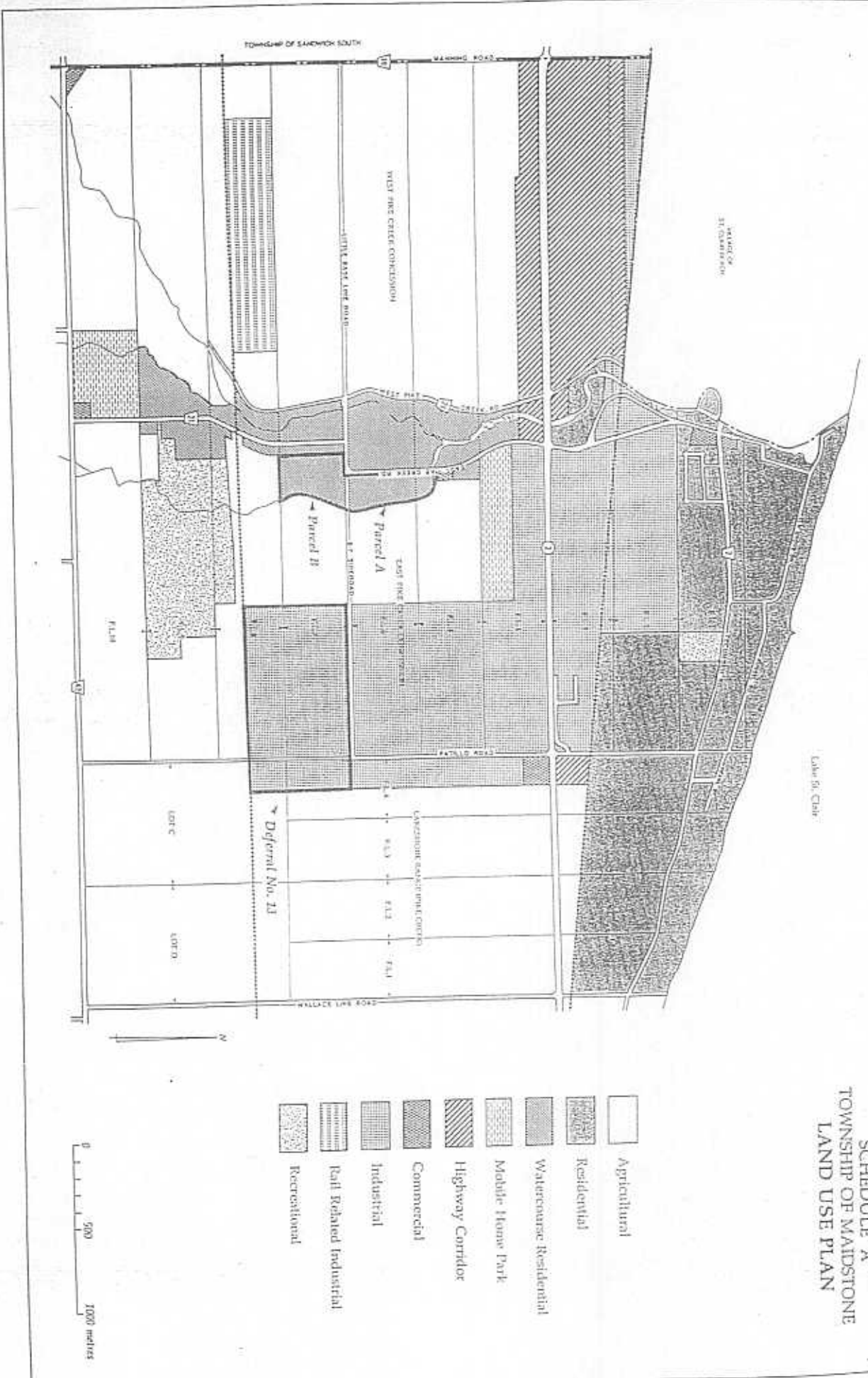

- Agricultural
- Residential
- Watercourse Residential
- Mobile Home Park
- Highway Corridor
- Commercial
- Industrial
- Rail Related Industrial
- Recreational

0 500 1000 meters

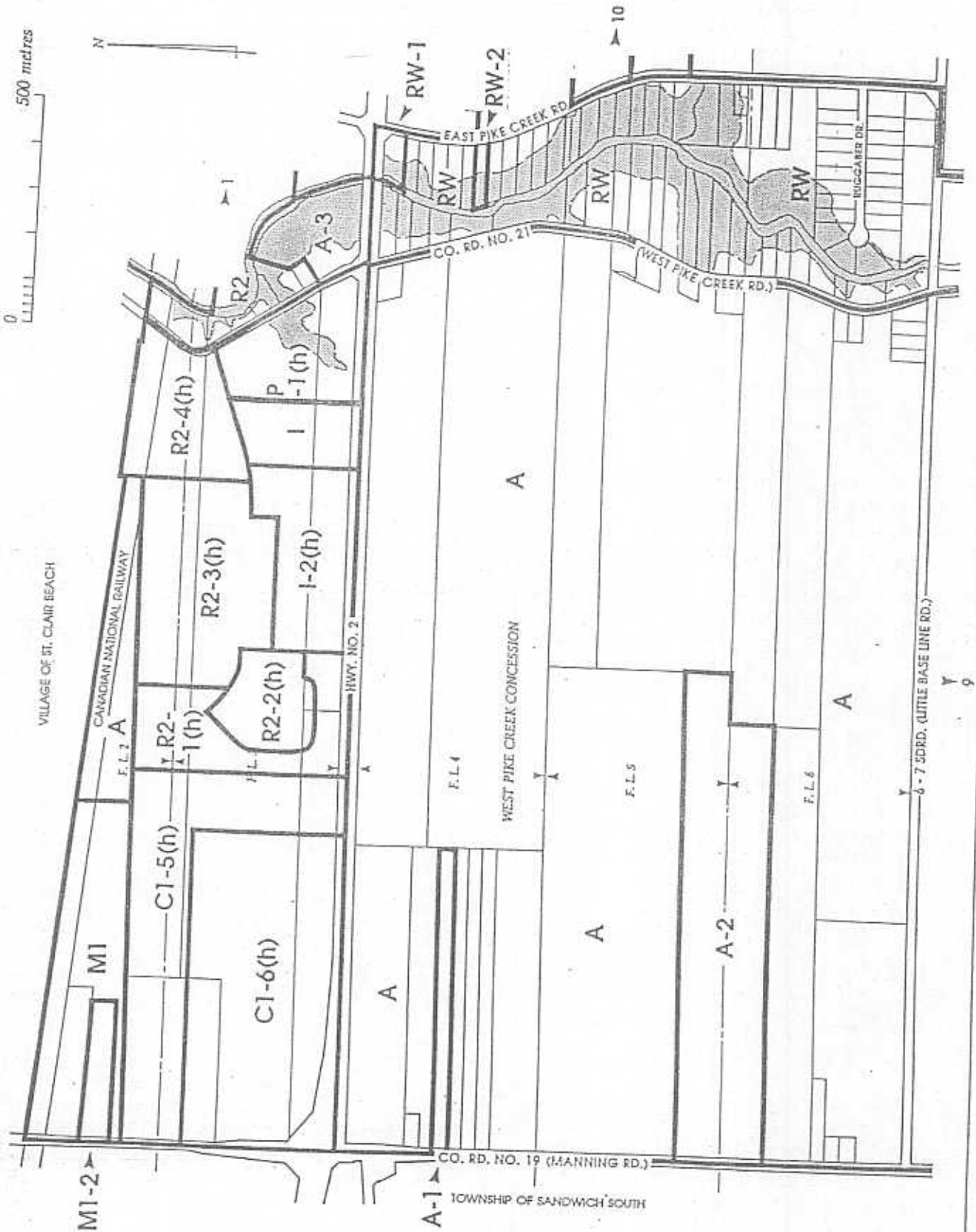

VILLAGE OF ST. CLAIR BEACH

CANADIAN NATIONAL RAILWAY

CO. RD. NO. 19 (MANNING RD.)
TOWNSHIP OF SANDWICH SOUTH

6-7 SECT. (LITTLE BASE LINE RD.)

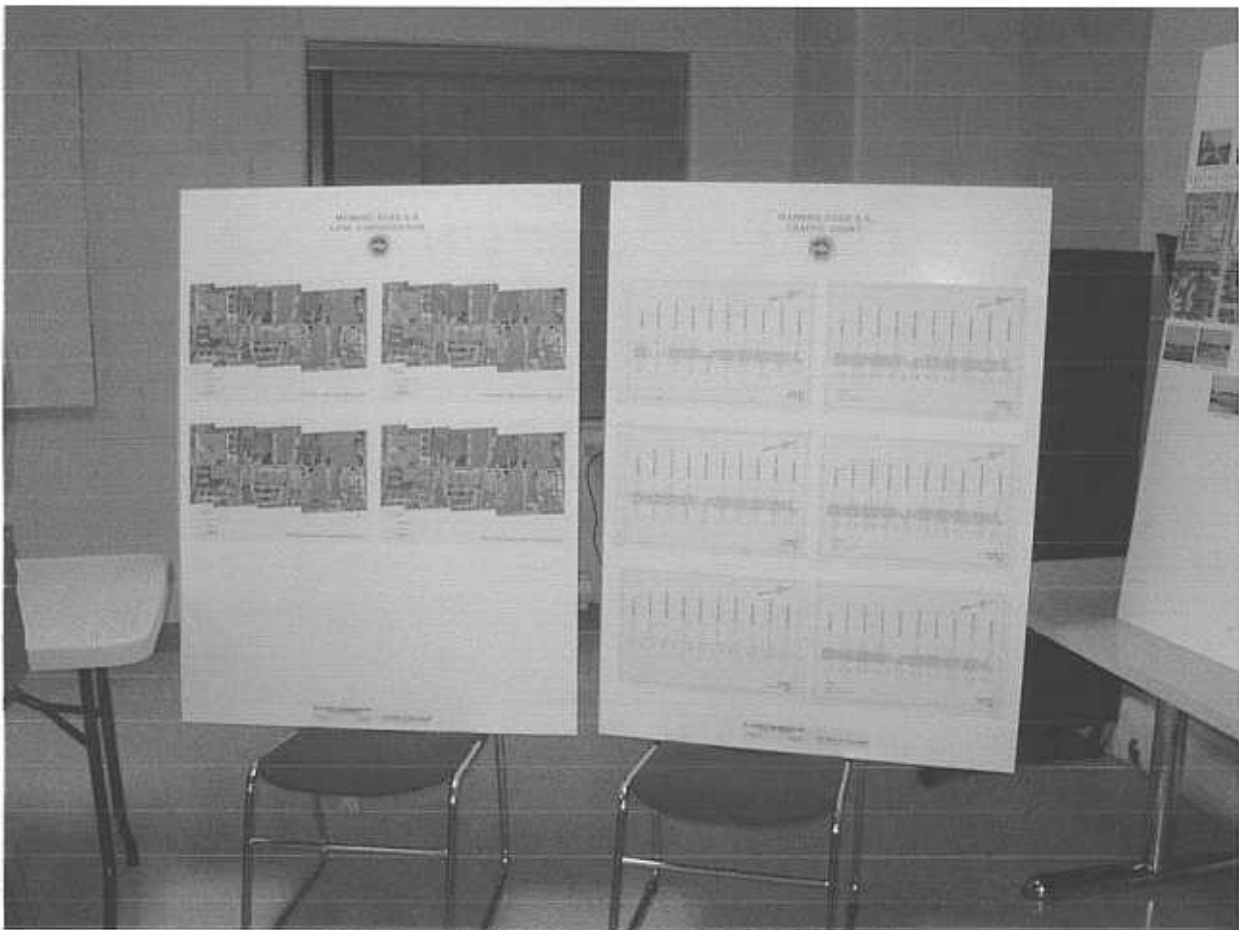

2004_0121_190635AA.jpg

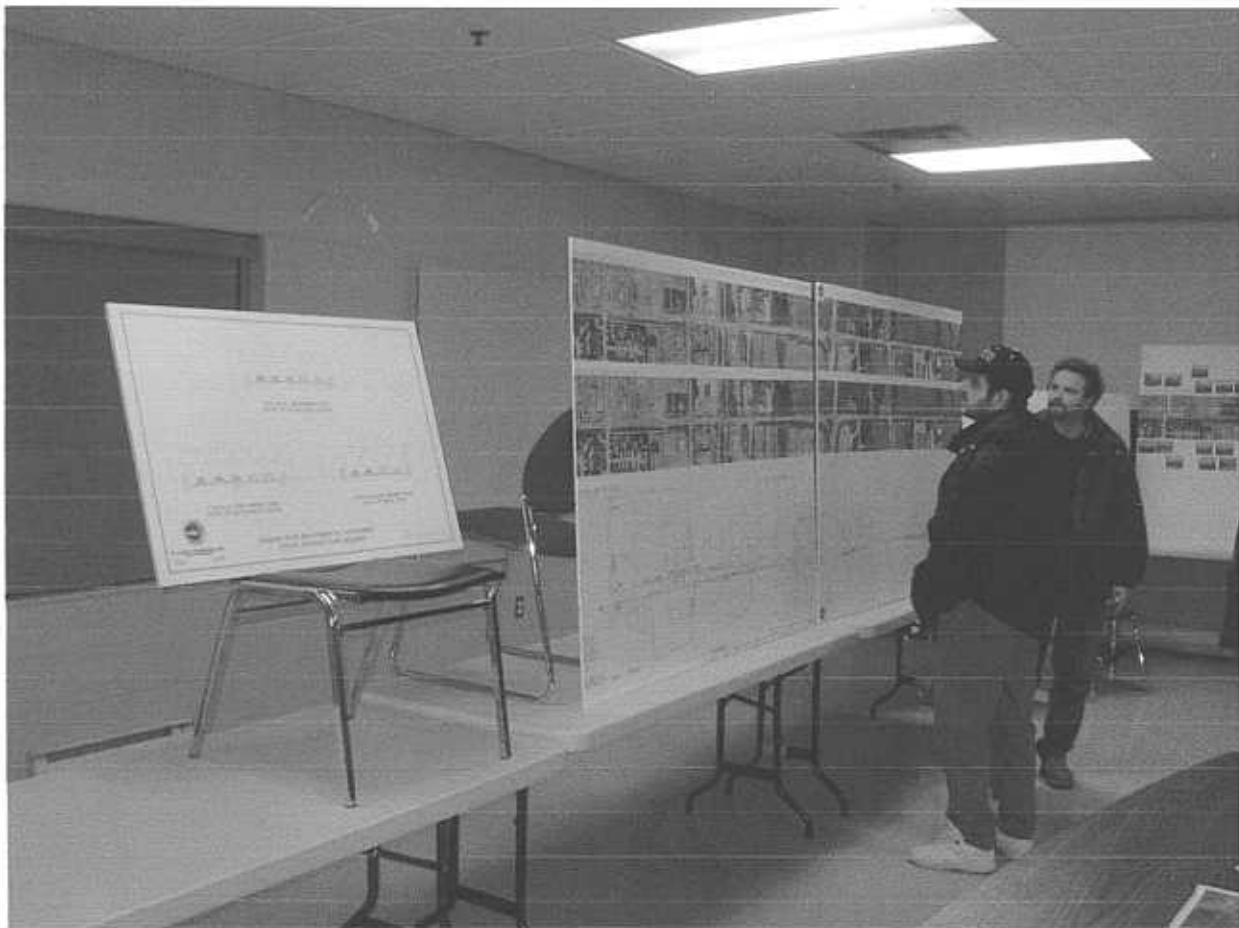

2004_0121_190654AA.jpg



MANNING ROAD - CLASS ENVIRONMENTAL ASSESSMENT
 THE CORPORATION OF THE COUNTY OF ESSEX
 PUBLIC INFORMATION CENTRE #1

WEDNESDAY, JANUARY 21st, 2004

NAME (PLEASE PRINT)	ADDRESS	TELEPHONE	SIGNATURE
GARY WENAMANT	190 RIVINGTON DR	735 6654	
JIM SYLVESTRÉ	1865 MANNING	735 6606	
MICHAEL SPENDIK	11828 HAWK LN.	739-1980	
Jeanine Mailloux	1149 Goyeau St.	973-6790	J. Mailloux
Joy Laramee	300 Gilles E. Suite B	254-5195	
Joss Zaccari	225 BRIGHTON	979-9435	
Nicole Zaccari	225 BRIGHTON S.C.B.	979 9435	N. Zaccari
Gary McAray	393 Amberly	739-0014	
VISH SOOD	641 Disenden H	739-2929	

MANNING ROAD - CLASS ENVIRONMENTAL ASSESMENT
 THE CORPORATION OF THE COUNTY OF ESSEX
 PUBLIC INFORMATION CENTRE #1



WEDNESDAY, JANUARY 21st, 2004

NAME (PLEASE PRINT)	ADDRESS	TELEPHONE	SIGNATURE
STU KESCH	419 AMBERCY CR., Tex.	735-1664	
ED KING	12146 OLIVER DR	735-1102	
Pauline NalKranian	1792 Manning Rd.	979-1154	
Jennifer S-Jean	1784 MANNING RD	979-6086	
Yerry Orr	1894 Manning Way	979-1419	
Roy Desrosiers	146 Cavada	978 8760	
FRED MARGUERITE GRANT	1776 MANNING	735-4129	
Rolf Klein	12501 James	9794555	

**MANNING ROAD - CLASS ENVIRONMENTAL ASSESSMENT
THE CORPORATION OF THE COUNTY OF ESSEX
PUBLIC INFORMATION CENTRE #1**



WEDNESDAY, JANUARY 21st, 2004

NAME (PLEASE PRINT)	ADDRESS	TELEPHONE	SIGNATURE
John POOLE	170 Arlington Blvd	735-7233	<i>John Poole</i>
PAT Stenenson	PO Box 84, Emeryville	727 3478	<i>Pat Stenenson</i>
FRANK VERGUNS	360 FAIRVIEW AVE WEST	ESSEX 776 6431	<i>Frank Verguns</i>
DAN MARION	1845 MANNING RD	735-0660	<i>Dan Marion</i>
MARY E. MARION	1845 MANNING RD	735-0660	<i>Mary E. Marion</i>
BOB WARONCHAK	479 CADA CRECENT	735-5199	<i>R. Waronchak</i>
Ron CAMPEAU	1820 MANNING RD	735-2697	<i>Ronald Campeau</i>
Lou REAUME	13385 Desro	735-3998	<i>Lou Reaume</i>

MANNING ROAD - CLASS ENVIRONMENTAL ASSESSMENT
 THE CORPORATION OF THE COUNTY OF ESSEX
 PUBLIC INFORMATION CENTRE #1



WEDNESDAY, JANUARY 21st, 2004

NAME (PLEASE PRINT)	ADDRESS	TELEPHONE	SIGNATURE
ERMINIO PETROZZI	2328 LEONARD RD.	9450605	CONCIDERATION FOR SANITARI E. Petrozzi 'SEWER
PAUL MORAND	1921 LESPERANCE RD	735-4073	Paul Morand
JEAN-PIERRE STEEN	1789 Manning Rd		Jean Pierre Steen
Len Kupisz	521 Estate Park	735-3355	Len Kupisz
TONY CICCONE	13167 HARVEST LN	255-9664	TONY CICCONE SANITARY SERVICES?
Bruno Cicccone	2076 Murray St.	735-7407	Bruno Cicccone SANITARY & SERVICES
Kévin Soucise	12140 Beauharnois	735-9434	Kévin Soucise
DAVID HOUEK	12530 Keith Ct	735-1494	David Houek

MANNING ROAD - CLASS ENVIRONMENTAL ASSESSMENT
 THE CORPORATION OF THE COUNTY OF ESSEX
 PUBLIC INFORMATION CENTRE #1



WEDNESDAY, JANUARY 21st, 2004

NAME (PLEASE PRINT)	ADDRESS	TELEPHONE	SIGNATURE
Toni Sanko	329 Burdick	735-4533	<i>Toni Sanko</i>
PHIL MONARD	735 BIRDICK	979 5849	<i>Phil Monard</i>

**R. LUCENTE ENGINEERING INC.
CONSULTING ENGINEERS**

MINUTES OF MEETING

Project: Environmental Assessment, Co. Rd. #19

Location: Tecumseh Public Works Office, Lacasse Boulevard

Time/Date: Wednesday, September 15, 2004 @ 9:00 a.m.

*Present: Mr. Roy Desjardin, Property Owner
Mr. Jerry Sovran, Property Owner
Mr. Avtar Kooner, Property Owner
Ms. Mary-Ann Keefner, Barrister & Solicitor – Miller Canfield
Mr. Larry Beaudoin, Director of Public Works – Town of Tecumseh
Mr. Tom Bateman, P.Eng., County Engineer – County of Essex
Mr. Rocco Lucente, P.Eng. – R. Lucente Engineering Inc.*

The meeting was requested by Mr. R. Desjardin to review proposed work on Co. Rd. 19, particularly how it would affect access at Desro Drive.

Mr. Desjardin, Mr. Sovran and Mr. Kooner own property which presently utilize Desro Drive to enter and exit at Co. Rd. 19.

R. Lucente produced the plan which was displayed at the first Public Information Centre held on January 21, 2004 and proceeded to explain that due to the proximity of the Desro intersection to Co. Rd.22 and the projected traffic count, the recommendations from the traffic engineer were to deny left-turn-in and left-turn-out at the Desro intersection. R. Lucente further explained that the Town of Tecumseh has agreed to extend Desro Drive farther west to interconnect with Sylvestre Drive, thereby offering a second means of access to Co. Rd. 19 at Jamsyl Drive. It is being recommended that the extension to Sylvestre Drive be completed before the reconstruction of Co. Rd. 19.

L. Beaudoin reported that this extension will be included in the 2005 budget for construction.

Mr. Desjardin and Mr. Sovran agreed that this second access to Sylvestre Drive and the right-in and right-out only at Co. Rd. 19 would be acceptable; however, Mr. Kooner continued to express his disfavour with the lack of access to Co. Rd. 19. He presently has a working arrangement with Mr. Sovran whereby a common driveway straddling the property line between the Kooner and Sovran properties is being used for access to Desro Drive. However, Mr. Kooner expressed his concern that a truck will not be able to negotiate the turn at Desro due to the configuration. L. Beaudoin suggested that the east/west access driveway to Kooner's property should be relocated farther south thereby allowing for better maneuverability by truck traffic.

It was further suggested that the 'S' curve on Desro could be reconfigured as well. Mr. Kooner continued to express his concern that he is being denied a second point of access to his property. L. Beaudoin stated that Mr. Kooner had the opportunity to negotiate a point of access to the west when the Sylvestre Drive development was being proposed but did not exercise it. L. Beaudoin further suggested that he should still pursue such an opportunity with Sylvestre while it still exists since lots on the east side of Sylvestre Drive backing onto the Kooner property remain free of buildings. It was further suggested that Mr. Kooner pursue the possibilities of an access road southerly from the middle point of his property to the south to Jamsyl Drive and also explore the possibility of an access road northerly to Desro Drive between buildings where space allows. He stated that he should not have been put in such a position and that the Town should have considered the developability of his property at the time of the Sylvestre Development.

The aerial photos and plans which were used at this meeting were requested by and submitted to Ms. Keefner. (Due to the nature of the aerial photographs, the superimposed property lines are not accurately depicted and should not be scaled).

END OF MINUTES

The above was recorded by the undersigned who should be advised of any error and/or omissions.



Rocco Lucente, P.Eng.

Distribution: All in attendance

/lb

(minutes\DesroDrive.doc)

Founded in 1852
by Sidney Davy Miller

**MILLER
CANFIELD**
MILLER, CANFIELD, PADDOCK AND STONE, P.L.C.

MARY-ANN KEEFNER
TEL: (519) 561-7409
FAX: (519) 977-1566
E-MAIL: keefner@millercanfield.com

Wilson Walker LLP
443 Ouellette Avenue, Suite 300, P.O. Box 1390
Windsor, Ontario, Canada N9A 6R4
TEL: (519) 977-1555/(313) 962-1990
www.millercanfield.com

MICHIGAN: Ann Arbor
Detroit • Grand Rapids
Howell • Kalamazoo
Lansing • Monroe • Troy

New York, NY
Pensacola, FL
Washington, DC

CANADA: Toronto • Windsor
POLAND: Gdynia
Katowice • Warsaw

August 20, 2004

RECEIVED AUG 24 2004
R. LUCENTE ENGINEERING INC.

The Corporation of the County of Essex
360 Fairview Avenue West
Essex, Ontario
N8M 1Y6

Attention: Tom Bateman

The Corporation of the Town of Tecumseh
Public Works
917 Lesperance Road
Tecumseh, Ontario
N8N 1W9

Attention: Larry Beaudoin

Lucente Engineering Inc.
3514 Walker Road
Windsor, Ontario
N8W 3S4

Attention: Rocco Lucente

Re: Reconfiguration of Manning Road
Our File No. 125717-00001

Dear Sirs:

This letter will confirm herein that we represent Mr. Roy Desjardins who owns a significant amount of property on Desro Drive in Tecumseh. I confirm that Mr. Desjardins has contacted you and has advised that he and other property owners and tenants on Desro Drive and the numerous charities who rent the bingo hall on Desro Drive on a daily basis will be affected by the reconfiguration of Manning Road to disallow a left hand turn from Manning Road onto Desro Drive. All of these owners and tenants collectively are of the opinion that the reconfiguration intended will severely reduce property values and have a significant negative impact on businesses located on Desro Drive. They also feel that the intended left hand turn onto Jamsyl Drive off Manning Road connecting to Sylvestre Drive and eventually Desro Drive from the west, is not a satisfactory resolution. They have a proposal for a further access to Desro Drive which would satisfy both themselves and hopefully the County of Essex and Town of Tecumseh. Mr. Desjardins is currently out of province but will return in two weeks and would appreciate your coordination of a meeting date to discuss the relevant issues herein. Mr. Desjardins has requested that any and all proceedings be delayed until such time as this meeting can take place.

MILLER, CANFIELD, PADDOCK AND STONE, P.L.C.

The Corporation of the County of Essex -2-
The Corporation of the Town of
Tecumseh
Lucente Engineering Inc.

August 19, 2004

Please contact me if you have any questions or concerns.

Very truly yours,

WILSON WALKER LLP

By: 

Mary-Ann Keefner

MAK/gel

c.c. Roy Desjardins

R. Lucente Engineering Inc.

From: "R. Lucente Engineering Inc." <rlucente@bellnet.ca>
To: <Bodrug_Mark@timhortons.com>
Sent: Monday, February 02, 2004 4:06 PM
Attach: AmyCroft-TIMHORTONS1.jpg
Subject: Re: Class EA - County Road No.19, Essex

Mark Bodrug,

In response to your e-mail of January 29, 2004, presently Manning Road and Amy Croft Drive is a signalized T-intersection. It is proposed that this will be a full intersection with an access road to the west for the future commercial development.

The road cross-section will consist of a northbound dedicated right turn lane to Amy Croft, two(2) northbound lanes and(1) dedicated left turn lane for the southbound traffic, the lane configuration will consist of a dedicated left turn lane and two(2) southbound lanes. Please review the attachment and if you have any other question, please contact this office.

Regards,
Rocco Lucente P.Eng.
R. Lucente Engineering Inc.

----- Original Message -----

From: <Bodrug_Mark@timhortons.com>
To: <rlucente@bellnet.ca>
Sent: Thursday, January 29, 2004 4:29 PM
Subject: Class EA - County Road No.19, Essex

R. Lucente, P.Eng.:

I have just received a copy of the letter for the January 21, 2004 Public Information Centre #1. As I was unable to attend the meeting, I am writing to ask if there are any changes proposed for the intersection of Manning Road and Amy Croft Drive. If there are any proposed changes, please contact me via e-mail or at (905) 339-6251 to discussed the extent those changes.

Thanks,
Mark Bodrug
Project Manager - Planning and Development

The information contained in this message is confidential and may be legally privileged. The message is intended solely for the addressee(s).

R. Lucente Engineering Inc.

From: "R. Lucente Engineering Inc." <rlucente@bellnet.ca>
To: <kathleen.freeman@cantire.com>
Sent: Tuesday, February 03, 2004 2:45 PM
Attach: CANADIAN-TIRE1.jpg
Subject: Re: County Rd. 19 Class EA

Att: Kathleen freeman

Here is the latest Proposed Aerial Plan showing the lanes on Manning Road and County Road 22.

If there are any questions, please contact me,

Thanks,
Rocco Lucente P.Eng.
R. Lucente Engineering Inc.

----- Original Message -----

From: kathleen.freeman@cantire.com
To: rlucente@bellnet.ca
Sent: Monday, January 19, 2004 11:27 AM
Subject: County Rd. 19 Class EA

Hi Rocco,

We (Canadian Tire Real Estate Limited) are in receipt of a letter sent by your office regarding a Public Information Centre to be held on January 21, 2004. We will not be available to attend. Would you send us a copy of the information to be provided to the public for our review.

We can be reached by fax at 416-487-6510 or by e-mail at kathleen.freeman@cantire.com.

Thanks for your help.

Kathleen
Kathleen Freeman
Development Manager
Real Estate Acquisitions
Tel: 416-487-6510
Fax: 416-480-3990

R. Lucente Engineering Inc.

From: "James Dodd" <James.Dodd@ca.mcd.com>
To: "R. Lucente Engineering Inc." <rlucente@bellnet.ca>
Sent: Tuesday, February 03, 2004 10:19 AM
Subject: RE: Manning Road Class E.A.

Thank you. I will review internally and provide comments if applicable.

James Dodd
Development Planner/Asset Management
McDonald's Restaurants of Canada Limited
McDonald's Place
Toronto, ON.
M3C 3L4

tel: 416.446.3760
fax: 416.446.3822
cell: 416.617.7433

-----Original Message-----

From: R. Lucente Engineering Inc. [mailto:rlucente@bellnet.ca]
Sent: Tuesday, February 03, 2004 10:19 AM
To: James Dodd
Subject: Manning Road Class E.A.

Att: Jim Dodd

Per our discussions yesterday, please review and call if you have any questions.

Thanks,
Rocco Lucente P.Eng.
R. Lucente Engineering Inc.

F.R. Berry & Associates

TRANSPORTATION PLANNING CONSULTANTS

660 Inverness Avenue
London, Ontario N6H 5R4
Tel: (519) 474 2527 Fax: (519) 474 1728

January 22, 2004

Our Ref.: 0405

R. Lucente Engineering Inc.
3514 Walker Road
Windsor, ON
N8W 3S4

Attn.: Mr. R. Lucente, P.Eng.

Dear Rocco:

RE.: MANNING ROAD ENVIRONMENTAL ASSESSMENT

As I mentioned to you yesterday, I have a few comments on the preliminary layout of Manning Road between St. Gregory's Road and Sylvestre Drive.

Currently there is a northbound right turn lane on the approach to Amy Croft Drive. This should be maintained since there is and will be a heavy right turn movement at this intersection. I suggest that there should be three lanes northbound all the way from County Road 22 to Amy Croft Drive.

From County Road 22 to south of Jamsyl Drive there should be two through lanes in each direction. Left turn lanes at Jamsyl and County Road 22 should be in addition to the through lanes. Because of the spacing of the intersections and the length of the left turn lanes, this probably means a five-lane section from County Road 22 to the south of Jamsyl Drive. This will provide a safer access to the five or six residences on the east side.

I question the need for sidewalks on Manning Road. If they are to be provided they should be set back at least 5 feet from the back of the curb.

An 86-foot right-of-way is very tight for a five-lane arterial, especially if sidewalks and underground services are to be provided. The usual standard for a five-lane arterial is 30.5 metres (100 feet).

Median islands at signalized intersections are desirable from a traffic control and safety point of view. They provide a point of reference for drivers, a location for signal poles and a pedestrian refuge.

Very truly yours
F.R. Berry & Associates

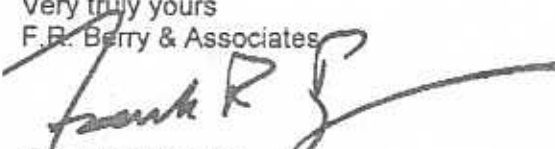
F.R. Berry, P.Eng.
Principal



TECUMSEH COMMUNITY HEALTH CARE CENTRE
13390 LANOUE STREET
TECUMSEH, ONTARIO
N8N 5E1

RECEIVED

JAN - 6 2004

January 2, 2004

Per:
TOWN OF TECUMSEH

To The Tecumseh BIA

Thank you for your request for a letter with regards to the expansion of Manning Road. As we were sending a letter to the Tecumseh Town Council with regards to this issue, we will send you a copy, as well as the owner of the Plaza, Mr. Dave Janisse and Tecumseh Town Council.

Please note, since coming to Tecumseh, at the Tecumseh Community Health Care Centre, it was to be that there was going to be a set of lights at Lanoue and Manning. This has become quite important, as there are no set of lights here, it is very difficult for our patients, many of whom are elderly, to make a left hand turn onto Manning Road from Lanoue and this could pose a hazard with regards to a motor vehicle accident. This is a very important issue as I was told when I came here that the patients would have a light at Lanoue, and as a safety issue there needs to be a light at Lanoue and Manning.

Thank you very much.



Dr. Haider Hasnain MD, CCFP, DOHS, MRO

CC:
Tecumseh Town Council
Mr. Dave Janisse

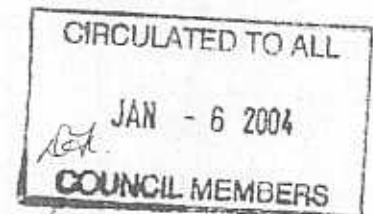

*Larry Beaudou
Rocco Lucette*

C. Council

*Larry Beaudou
Rocco Lucette*



PUBLIC INFORMATION CENTRE #1
MANNING ROAD
CLASS ENVIRONMENTAL ASSESSMENT
THE CORPORATION OF THE COUNTY OF ESSEX
WEDNESDAY, JANUARY 21st, 2004

COMMENT SHEET

NAME (PLEASE PRINT): John Poole
ADDRESS: 170 ARLINGTON Blvd
TELEPHONE: 735-7233
FAX:
E-MAIL: JNPOOLE1@COBECO.CA

MY COMMENTS ARE AS FOLLOWS:

I would like to see the project completed as
quickly as possible to release the traffic congestion
we now live with.

SIGNATURE :

John Poole

ATTENTION: Roeco



PUBLIC INFORMATION CENTRE #1
MANNING ROAD
CLASS ENVIRONMENTAL ASSESSMENT
THE CORPORATION OF THE COUNTY OF ESSEX
WEDNESDAY, JANUARY 21st, 2004

COMMENT SHEET

NAME (PLEASE PRINT): DAH & MARY MARION Feb 2/04
 ADDRESS: 1845 MANNING RD
 TELEPHONE: 735-7025
 FAX: 735 5857
 E-MAIL: _____

MY COMMENTS ARE AS FOLLOWS:

- 1/ Why is Manning Rd. proposed to be widened South of the Express Way
- 2/ If water lines & gas lines are to be moved - who will be responsible for the cost
- 3/ If the road is widened & the drain is covered, what will happen to the water drainage from the road - most property owners are lower than the road?
- 4/ Will speed limits be reduced
- 5/ Will there be any direct cost to property owners?

SIGNATURE: Mary Marion



PUBLIC INFORMATION CENTRE #1
MANNING ROAD
CLASS ENVIRONMENTAL ASSESSMENT
THE CORPORATION OF THE COUNTY OF ESSEX
WEDNESDAY, JANUARY 21st, 2004

COMMENT SHEET

NAME (PLEASE PRINT): DAN MARION

ADDRESS: 1845 MANNING ROAD

TELEPHONE: 735-7025

FAX: 735-5857

E-MAIL: _____

MY COMMENTS ARE AS FOLLOWS:

- (1) WHAT ABOUT NEW SEWER LINES, WHEN, WHERE
AND HOW MUCH.
- (2) PROPERTY DAMAGE ON OWNERS PART, WHO'S
RESPONSIBILITY.
- (3) WHAT PORTION OF MANNING ROAD WILL BE
UNDER CONSTRUCTION AT ONE TIME.
- (4) WHAT IS THE DURATION OF PROJECT FROM
START TO FINISH.

SIGNATURE :

Dan Marion

1/21/04



PUBLIC INFORMATION CENTRE #1
MANNING ROAD
CLASS ENVIRONMENTAL ASSESSMENT
THE CORPORATION OF THE COUNTY OF ESSEX
WEDNESDAY, JANUARY 21st, 2004

COMMENT SHEET

NAME (PLEASE PRINT): DAN MARCON

ADDRESS: 1845 MANNING RD-

TELEPHONE: 735-0660

FAX: 735-5857

E-MAIL: _____

MY COMMENTS ARE AS FOLLOWS:

SEWAGE LINES, WILL THEY BE PUT IN BEFORE
ROAD CONSTRUCTION STARTS. IF NOT WHY NOT
WILL PROPERTIES ON BOTH SIDES OF ROAD
BE EQUAL AS FAR AS EXPROPRIATION

SIGNATURE :

Dan Marcon



**PUBLIC INFORMATION CENTRE #1
MANNING ROAD
CLASS ENVIRONMENTAL ASSESSMENT
THE CORPORATION OF THE COUNTY OF ESSEX
WEDNESDAY, JANUARY 21st, 2004**

COMMENT SHEET

NAME (PLEASE PRINT): MARY MARION

ADDRESS: 1845 MANNING RD

TELEPHONE: 519-735-0660 Home 735 7025

FAX: 735 5857

E-MAIL: _____

MY COMMENTS ARE AS FOLLOWS:

My Mail Box is on the East side of Manning
- How will I be getting my mail?

What will the speed limit be?

The traffic is already moving over the
speed limit.

- How much of my property will you be taking

- Is it necessary to widen the road to 4 lanes

up to SYLVESTER Drive.

SIGNATURE : Mary Marion



PUBLIC INFORMATION CENTRE #1
MANNING ROAD
CLASS ENVIRONMENTAL ASSESSMENT
THE CORPORATION OF THE COUNTY OF ESSEX
WEDNESDAY, JANUARY 21st, 2004

COMMENT SHEET

NAME (PLEASE PRINT): EDWARD KING
ADDRESS: 12146 OLIVER DR
TELEPHONE: 735-1102
FAX: _____
E-MAIL: _____

MY COMMENTS ARE AS FOLLOWS:

THE OPENING OF MANNING ROAD
SOUTH OF E.C ROW WOULD OPEN
THIS UP AS A TRUCK ROUTE OFF
OF THE 401. ALSO TAKING 2 LANES
OF TRAFFIC DOWN TO 1 LANE AT
ST GREGORY WILL CREATE A REAL
BOTTLE NECK.

A TAX INCREASE SHOULD NOT BE
PUT ON SPECIFIC TO THIS PROJECT

SIGNATURE :

Edward King



PUBLIC INFORMATION CENTRE #1
MANNING ROAD
CLASS ENVIRONMENTAL ASSESSMENT
THE CORPORATION OF THE COUNTY OF ESSEX
WEDNESDAY, JANUARY 21st, 2004

COMMENT SHEET

NAME (PLEASE PRINT): Roy Desjardins
ADDRESS: 146 Cove de la Tce
TELEPHONE: 979 8718
FAX: 979 7784
E-MAIL: RoyDesjardins@yahoo.ca

MY COMMENTS ARE AS FOLLOWS:

INCREASED TRUCK TRAFFIC MOST CERTAIN CERTAIN
CONGESTION AS ON HYRON CHURCH IS A POSSIBILITY
OPEN UP DESRTE TO ACCESS SYLVETTE DR ASAP

SIGNATURE :

Roy Desjardins



PUBLIC INFORMATION CENTRE #1
MANNING ROAD
CLASS ENVIRONMENTAL ASSESSMENT
THE CORPORATION OF THE COUNTY OF ESSEX
WEDNESDAY, JANUARY 21st, 2004

COMMENT SHEET

NAME (PLEASE PRINT): MICHAEL SPENDIK
ADDRESS: 11828 HAWK LN
TELEPHONE: 739-1980
FAX: _____
E-MAIL: mspendik@sympatico.ca

MY COMMENTS ARE AS FOLLOWS:

- N. ENTRANCE/EXIT @ EXISTING SHOPPERS SHOULD NOT HAVE LEFT OUT (PROPOSED ACCESS)
- DON'T BEND ROAD IN BETWEEN TECUMSEH RD. & PLAZA LITE TO NORTH (KEEP DIVIDER IN ALL DISTANCE)
- KEEP 2 THRU LANES CONTINUOUS ON NORTH BOUND MANNING APPROCHING HWY 22 & KEEP 2 LEFT LANE SEPARATE
- HAVE CENTER LEFT LANE ON MANNING FROM HWY 22 TO SYLVESTRÉ DRIVE - DEVELOPMENT IN AREA WILL CAUSE CONJESTION LIKE WALKER SOUTH OF EXPRESSWAY

SIGNATURE : M. Spendik



PUBLIC INFORMATION CENTRE #1
MANNING ROAD
CLASS ENVIRONMENTAL ASSESSMENT
THE CORPORATION OF THE COUNTY OF ESSEX
WEDNESDAY, JANUARY 21st, 2004

COMMENT SHEET

NAME (PLEASE PRINT): FRED & MARGUERITE GRANT
ADDRESS: 1776 MANNING
TELEPHONE: 735-4129
FAX: 735-4129
E-MAIL: MARG 002 @ SYMPATICO.CA

MY COMMENTS ARE AS FOLLOWS:

THE TRANSPORT TRAFFIC HAS BECOME VERY
HEAVY & WILL LIKELY INCREASE WITH THE
CHANGES PLANNED. THIS SHOULD BE CONSIDERED
IN THE PLANNING PROCESS. ALSO THE TRUCKS
USE THEIR ENGINE BRAKES FOR NO REASON,
SIGNS SHOULD BE ERECTED BEFORE JAWSYL
DR. REQUESTING TRUCKERS NOT USE TAKE BRAKES

SIGNATURE :

M. Grant



PUBLIC INFORMATION CENTRE #1
MANNING ROAD
CLASS ENVIRONMENTAL ASSESSMENT
THE CORPORATION OF THE COUNTY OF ESSEX
WEDNESDAY, JANUARY 21st, 2004

COMMENT SHEET

NAME (PLEASE PRINT): Jennifer St Jean
ADDRESS: 1784 MANNING Rd.
TELEPHONE: 979-6086
FAX: _____
E-MAIL: SP Jen@Sympatico.ca.

MY COMMENTS ARE AS FOLLOWS:

My house is very close to the road as
~~my~~ my main concern is the safety
of my 3 children. The light being at
Jamsyl De will make it very difficult
to access my property. They should move it
to Sylvester dr.

SIGNATURE :

Jennifer St Jean



PUBLIC INFORMATION CENTRE #1
MANNING ROAD
CLASS ENVIRONMENTAL ASSESSMENT
THE CORPORATION OF THE COUNTY OF ESSEX
WEDNESDAY, JANUARY 21st, 2004

COMMENT SHEET

NAME (PLEASE PRINT): Pauline NalKranian
ADDRESS: 1792 Manning Rd.
TELEPHONE: 979-1154
FAX: _____
E-MAIL: _____

MY COMMENTS ARE AS FOLLOWS:

I do not like the idea of a traffic light at Jamsyl Dr. - It should be further out at Sylvester Dr.

I am okay with the widening of Manning Rd because it definitely needs it. There is always traffic in front of my home at all times and I have 3 young children. I just hope that construction will not take a long time once started.

SIGNATURE :

Pauline NalKranian

Please Keep Me informed on future developments this matter Thanks.



PUBLIC INFORMATION CENTRE #1
MANNING ROAD
CLASS ENVIRONMENTAL ASSESSMENT
THE CORPORATION OF THE COUNTY OF ESSEX
WEDNESDAY, JANUARY 21st, 2004

COMMENT SHEET

NAME (PLEASE PRINT): JAMES SYLVESTRE
ADDRESS: 1865 MANNING RD
TELEPHONE: 735 6606
FAX: 735 1603
E-MAIL: _____

MY COMMENTS ARE AS FOLLOWS:

- RESIDENTIAL SUBDIVISION ACCESS @
BAILLARGON DRAIN SHOULD BE INCLUDED
IN STUDY
- EFFECT ON RESIDENCE @ 1951
(HOUSE IS VERY CLOSE TO LOT LINE)

SIGNATURE : _____



PUBLIC INFORMATION CENTRE #1
MANNING ROAD
CLASS ENVIRONMENTAL ASSESSMENT
THE CORPORATION OF THE COUNTY OF ESSEX
WEDNESDAY, JANUARY 21st, 2004

COMMENT SHEET

NAME (PLEASE PRINT):

Jean PIERRE ST JEAN

ADDRESS:

1784 MANNING Rd.

TELEPHONE:

FAX:

E-MAIL:

MY COMMENTS ARE AS FOLLOWS:

*I hope we can get
out of our driveways to get to work
and everyday things.*

SIGNATURE :



**PUBLIC INFORMATION CENTRE #1
MANNING ROAD
CLASS ENVIRONMENTAL ASSESSMENT
THE CORPORATION OF THE COUNTY OF ESSEX
WEDNESDAY, JANUARY 21st, 2004**

COMMENT SHEET

NAME (PLEASE PRINT): JOHN KOPECK
ADDRESS: 1879 LA ESPERANCE / 13300 TECUMSKH RD. E
TELEPHONE: 519 735 5653
FAX: 519 735 0445
E-MAIL: /

MY COMMENTS ARE AS FOLLOWS:

TWO LANE FROM REC ROW TO SILVERSTAR DRIVE + TURNING

SIGNATURE : _____



PUBLIC INFORMATION CENTRE #1
MANNING ROAD
CLASS ENVIRONMENTAL ASSESSMENT
THE CORPORATION OF THE COUNTY OF ESSEX
WEDNESDAY, JANUARY 21st, 2004

COMMENT SHEET

NAME (PLEASE PRINT): VISH SOOD
ADDRESS: 641 DRESDEN R
TELEPHONE: 739-2929
FAX: 735-7609
E-MAIL: Vishsood@Champion2100.com

MY COMMENTS ARE AS FOLLOWS:

MANNING RD - NORTH BOUND FROM #22, SHOULD
HAVE RIGHT TURN ^{ALL THE WAY} LANE FROM #22 TO AMY
CROFT DR TO FACILITATE 2-NORTH BOUND
TRAFFIC TO GO STRAIGHT. IT IS IMPORTANT, AS
FROM #22 TO LEFT TURN LANES (NORTH BOUND) TO
MANNING RD COULD HAVE TRAFFIC JAM IF THERE ARE
3-4 CARS TURNING EAST ON AMY CROFT DR. THIS SOBEY'S
PLAZA IS BUILT ONLY 20-25% OF TOTAL PROJECTED BUILDING
AREA. THIS PLAZA EXPECTED TO BE COMPLETED IN 3-4 YEARS.
AND IT CAN CAUSE A BIG TRAFFIC PROBLEM.

SIGNATURE :