

R. Lucente Engineering Inc.

From: "R. Lucente Engineering Inc." <rlucente@bellnet.ca>
To: "Graham Kueneman - Post" <graham.kueneman@canadapost.ca>
Cc: "Tim Mousseau - Lakeshore" <tmousseau@townoflakeshore.on.ca>; "Larry Beaudoin - Tecumseh" <lbeaudoin@town.tecumseh.on.ca>; "Tom Bateman - Essex" <tbateman@countyofessex.on.ca>
Sent: Tuesday, August 24, 2004 9:42 AM
Attach: MANNING-8x11-5.jpg; MANNING-8x11-2.jpg; MANNING-8x11-3.jpg; MANNING-8x11-4.jpg; MANNING-8x11-1.jpg
Subject: Manning Road E.A. - (e-mail 1)

Att: Graham Kueneman, Canada Post

This is to confirm our discussion of Aug. 20 regarding the proposed improvements and widening of County Road 19 near County Road 22.

We are forwarding for you information our proposed plans which were displayed for public viewing on Jan.21/04. This project is still in the Environmental Assessment stage with construction not anticipated for 2 or 3 years.

We would like to meet with you to review how this will affect delivery and how to make alternate arrangements.

Another e-mail will follow also with the proposed lanes on aerial photo for County Road 19(Manning Road) due to the size of .jpgs sheets.

Regards,
Rocco Lucente P.Eng.
R. Lucente Engineering Inc.



Dale Wells
Delivery Planning & Postal Code
300 Wellington Street
London On N6B 3P2

February 3, 2005

R. LUCENTE ENGINEERING INC.
RECEIVED FEB 04 2005

Rocco Lucente
Engineering Inc.
3514 Walker Road Unit 1
Windsor On N8W 3S4

Subject: Manning Road (county rd 19) proposed Reconstruction.

It is my understanding that this proposed work might begin in the next 2 or 3 years.

I have met with the Rural Service Representative for Canada Post and we have agreed to the following.

The following addresses will receive door-to-door delivery **immediately** by contractor and their Rural Mailbox will not be used in the future for mail delivery.

- Tecumseh Auto Spa
- 1630 Manning Rd – Animal Hospital
- 1654 Manning Rd – Tecumseh Golf
- 1825 Manning Rd – Fire Place Bus.
- 1845 Manning Rd – Storage Business
- And the Rural Mail Box located at Plaza Entrance will be removed.

The following addresses will **continue** to receive Rural Mail Box delivery until such time as the work begins along Manning Rd. When the work begins, Canada Post will provide **temporary** mail delivery to a Group Mail Box at a location that is deemed safe for mail pick up and delivery near the existing area. Canada Post will expect the project contractor to make the temporary location accessible to all residents and mail delivery personnel. When work is complete Canada Post Corporation will install a **Community Mailbox** at a Lay-by location provided by the municipality (project contractor) on the East side of Manning Rd in the proximity of these addresses. Rural Mail Box delivery will no longer

be possible along this route as barrier curbs and the four-lane road will be deemed unsafe for our delivery personnel.

- 1740 Manning Rd
- 1758 Manning Rd
- 1766 Manning Rd
- 1768 Manning Rd
- 1776 Manning Rd
- 1784 Manning Rd
- 1792 Manning Rd
- 1820 Manning Rd
- 1845 Manning Rd
- 1984 Manning Rd

Regards Dale Wells

CC: Local Office
Rural Services - M. Shoebottom

- 1740 Manning Rd
- 1758 Manning Rd
- 1766 Manning Rd
- 1768 Manning Rd
- 1776 Manning Rd
- 1784 Manning Rd
- 1792 Manning Rd
- 1820 Manning Rd
- 1845 Manning Rd
- 1984 Manning Rd

File

TECUMSEH

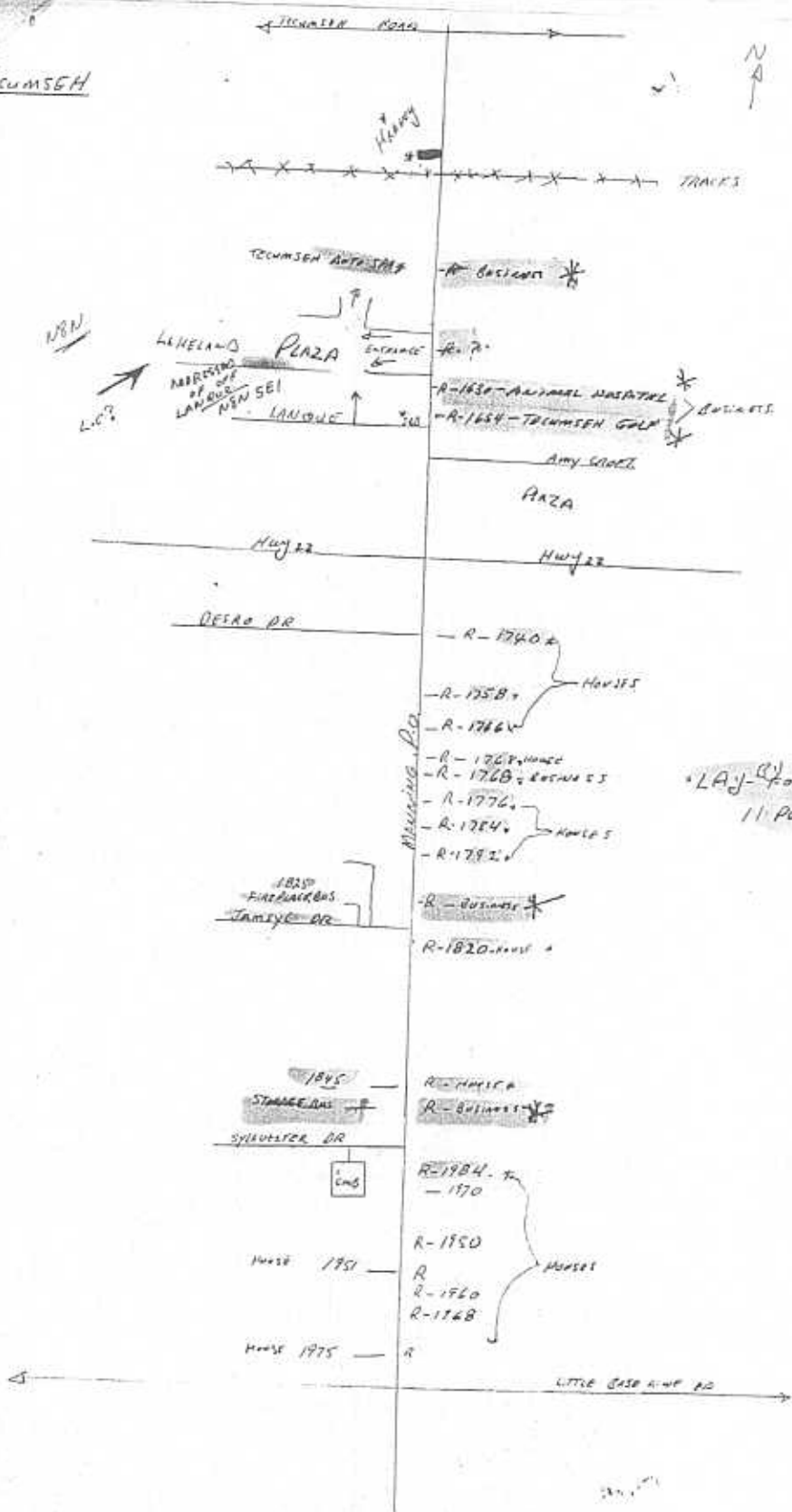

DELIVERY TO THE DOOR BY CONTRACTOR.

DELIVERY TO CMB FUTURE IN LAYBY EAST SIDE

R. Lucente Engineering Inc.

From: "R. Lucente Engineering Inc." <rlucente@bellnet.ca>
To: "Tom Bateman - Essex" <tbateman@countyofessex.on.ca>
Sent: Thursday, February 24, 2005 10:37 AM
Attach: SUPER MAIL BOX.dwg
Subject: Manning Road

Hello Tom,

Per Dale Wells' correspondence of Feb. 3, 2005 we have selected a location for the community mail box. We have attached a plan indicating the location of the lay-by for your comments.

If you have any questions please contact this office.

Regards,
Rocco Lucente P.Eng.
R. Lucente Engineering Inc.

2/24/05

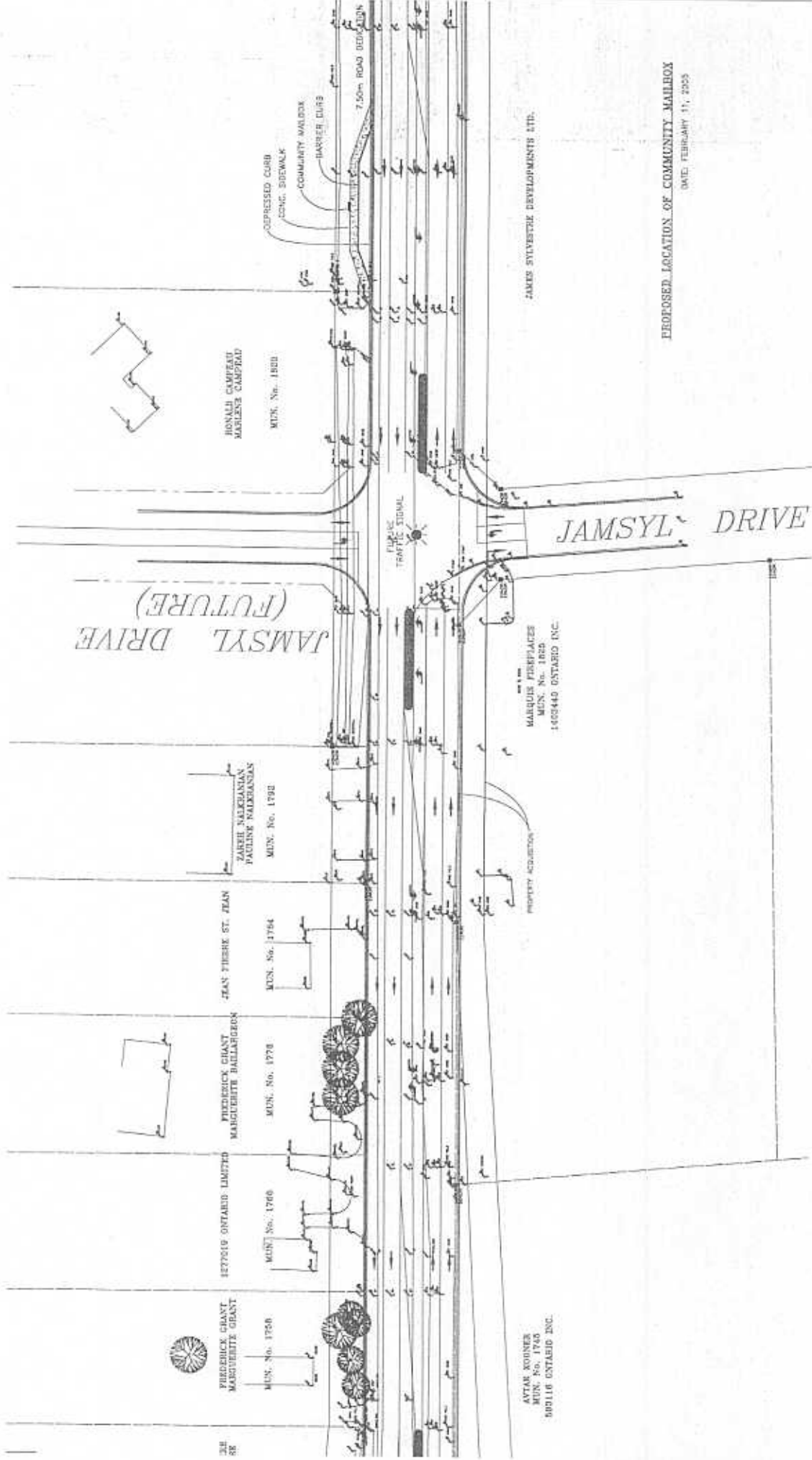

PROPOSED LOCATION OF COMMUNITY MAILBOX
 DATE: FEBRUARY 11, 2025

R. Lucente Engineering Inc.

From: "R. Lucente Engineering Inc." <rlucente@bellnet.ca>
To: "Engineering Lucente" <rlucente@bellnet.ca>
Sent: Tuesday, March 22, 2005 11:13 AM
Subject: Fw: County Road 19 - Essex

----- Original Message -----

From: R. Lucente Engineering Inc.
To: Graham Kueneman - Post
Cc: Tom Bateman - Essex
Sent: Tuesday, March 22, 2005 11:09 AM
Subject: County Road 19 - Essex

Graham:

We are in receipt of the Feb. 3, 2005 letter from Dale Wells.

We have concerns with the delivery to 1845 Manning Rd. Dale reported that delivery would be made to the next door commercial property and that the 1845 customer would have to make arrangements to pick up the mail at that location. I am not certain if that is the case at all times or only when the deliverer is unable to enter the residential driveway. Dale is concerned that it may be difficult to turn into a residential driveway during the winter months since it less likely for the driveway of a residence to be cleared as soon or as well as a commercial driveway.

Could you please clarify this with Dale and get back to us. Has any discussion taken place with the residents at 1845 regarding this arrangement?

Another concern expressed by the County Engineer's Office is the proposed location of the community mailbox lay-by being on such a busy road.

Regards;

Rocco

MAILBOX - OPTION 1

MUN. No. 1792
SARHI NALPRANYAN
PATRINE NALKRANYAN

MUN. No. 1764

JEAN PIERRE ST. JEAN

MUN. No. 1885

RONALD CAMPBELL
MADLENE CAMPBELL

MANNING ROAD
(ESSEX COUNTY ROAD No. 10)
7.50m ROADWAY

DEPRESSED CURB

COMMUNITY MAILBOX

CONC. SIDEWALK

BARRIER CURB

FUTURE TRAFFIC SIGNAL

JAMSYL DRIVE

1405440 OHTARD INC.

R. LUCENTE ENGINEERING INC.
CONSULTING ENGINEERS

21 King Ave. #201
Waltham, MA 02451
Tel: 781.881.1111
Fax: 781.881.1112
www.rlucente.com

Aerial Photo Taken: 2004

JAMES STILLWATER DEVELOPMENTS LTD.

SCALE: 1:750
DATE: APRIL 6, 2005



MUN. No. 1780

MUN. No. 1776

MUN. No. 1784

MUN. No. 1792

1277019 ONTARIO LIMITED

FREDERICK GRANT
MARGUERITE BALLARGRON

JEAN PIERRE ST. JEAN

KARBU NALKRANIAN
PAULINE NALKRANIAN

FUTURE LOCATION OF
1.8m CONCRETE SIDEWALK
BY TOWN OF LAKESHORE

MANNING ROAD

(ESSEX COUNTY ROAD No. 19)

7.50m ROADWAY

JAMSYL DRIVE
(FUTURE)

FUTURE LOCATION OF
1.8m CONCRETE SIDEWALK
BY TOWN OF LAKESHORE

1408440 ONTARIO INC.

MUN. No. 1005

SCALE: 1:750
DATE: APRIL 11, 2005

R. LUCENTE ENGINEERING INC.
CONSULTING ENGINEERS

211 Miller Ave. 2nd Fl.
Water, Ontario, Canada
N2L 2K6

Phone: (519) 885-8888
Fax: (519) 885-8888
E-mail: rlucente@reinc.ca



MLN. No. 1020

RONALD CAMPEAU
MARLENE CAMPEAU

FUTURE LOCATION OF
1.8m CONCRETE SIDEWALK
BY TOWN OF LAKESHORE

DEPRESSED CURB

COMMUNITY MAILBOX

CONC. SIDEWALK

BARRIER CURB

7.50m ROADWAY DEDICATION

FUTURE
TRAFFIC SIGNAL

JAMSYL DRIVE

FUTURE LOCATION OF
1.8m CONCRETE SIDEWALK
BY TOWN OF LAKESHORE

JAMES SYLVESTRE DEVELOPMENTS LTD.

PREFERRED SOLUTION